

# THIEME

**THIEME 3000**



**3/4-automatic, flatbed, shuttle table  
screen printing machine**

## Details of the THIEME 3000

Modular constructed chassis made from specially designed, low mass, aluminum extruded profiles.

### Printing Table

The printing table consists of a sandwiched construction with a wear-resistant oxide layer of anodized aluminum. Pneumatic lay on pins (rear, left and right side) are separately selectable. The table motion is free from vibrations, running on wear resistant guide rails. The bearings are closed to avoid any contamination and to ensure smooth operation.

### Vacuum System

A high-volume fan provides a fast set-up of the vacuum. Vacuum and blow-back are controlled via a reversible valve and are infinitely adjustable in volume. The pre-vacuum time is infinitely controllable. The blow-back device guarantees undisturbed take-off of the substrate and is completely adjustable to match the take off gripper timing.

### Take-off System

The grippers are suitable for flexible and rigid materials, the holding force of the grippers increasing proportionally with the material thickness. Take-off positions can be chosen to the rear, left or right side. The transport belt speed is programmable to match individual dryer speeds.

### Screen Frame Guidance System

The pneumatic frame clamping allows a positive locking of the screen frame. The pneumatic clamping of the master frame avoids unnecessary walking around the machine. The precise fine tune adjustment is performed via 3 micro spindles within an



adjusting range of +/- 5 mm (1/5"). The 3-point centering device allows exact positioning of the frame which is absolutely required when using a register system.

### Print Head

The print head is electronically controlled. The height of lift is approx. 40mm (1 1/2"). A cleaning position, with an automatic power cut off for safety, lifts up to 500mm (20") for easy access.

### THIEME Squeegee Unit (pat.)

Pneumatic "inversion" cylinders are made responsible for the changeover from flood to print and vice-versa. The squeegee pressure is controlled pneumatically, with automatic adjustment of parallelism to the plane of the printing table. The angles of squeegee and flood-coater are infinitely adjustable, where contact with the screen is never lost. The insertion and removal of the squeegee

## Technical Data

Type of machine	3010	3020	3030	3040
print size (mm inch)	550 x 750 22 x 30	750 x 1050 30 x 41	1000 x 1400 39 x 55	1200 x 1600 47 x 63
print size max. (mm inch)	570 x 770 22 x 30	770 x 1070 30 x 42	1020 x 1410 40 x 56	1220 x 1660 48 x 65
sheet size max. (mm inch)	580 x 780 23 x 31	780 x 1080 31 x 43	1030 x 1420 41 x 56	1230 x 1670 48 x 66
frame size (mm inch)	1000 x 1100 39,3 x 43,3	1200 x 1400 47,2 x 55,1	1450 x 1750 57,0 x 68,8	1700 x 2000 66,9 x 78,7
print table – external dimension (mm inch)	800 x 1000 31 x 39	1000 x 1300 39 x 51	1250 x 1650 49 x 65	1450 x 1900 57 x 75
size of vacuum field (mm inch)	570 x 765 22 x 30	765 x 1065 30 x 42	1020 x 1410 40 x 56	1215 x 1665 48 x 66
max. range of substrate thickness (mm inch)	50 2	50 2	50 2	50 2
screen fine tuning X-X-Y (mm inch)	+/- 5 +/- 0,2	+/- 5 +/- 0,2	+/- 5 +/- 0,2	+/- 5 +/- 0,2
squeegee speed (m/sec inch/sec)	0,2–1,4 8–55	0,2–1,4 8–55	0,2–1,4 8–55	0,2–1,4 8–55
appr. weight (kg lb)	1250 2756	1350 2976	1600 3527	1800 3968
speed* (cycl/h)	1120	960	780	680
power supply (V)	400 / 230	400 / 230	400 / 230	400 / 230
circuit connection (kW)	2,8	2,8	2,8	2,8
consumption (A)				4/400 V / 7/230 V

\* Mechanical machine speed w/o feeding operation and print head movement

All technical information is not binding and subject to change without notice.

takes place in a matter of seconds with integrated, quick-action camlocks, using no tools or separate clamping devices.

### Squeegee Control

Squeegee and flood-coater speeds are independently programmable. The virtually maintenance free linear ball bearing guidance system maintains perfect, chatter free movements. The squeegee stroke length is infinitely adjustable via the operation panel.

### Off-Contact Adjustment

For different screen tensioning and material thickness, the off-contact can be precisely adjusted from 4 to 50 mm (5/32" to 2") via an external dial controller.

### Peel-off Device

The peel-off height is infinitely adjustable from 0 to 4 mm per 200 mm (0 to 5/32" per 8") of stroke length. The peel-off "datum" or starting point is infinitely adjustable across the squeegee stroke length.



### THIEME Control

Using the programmable electronic control, set-up times can be reduced enormously. Print jobs are reproducible and the working procedures are safe, hence reducing production costs.



THIEME screen printing machines can be used for a variety of applications. Machine features are based on the requirements of each individual customer and are governed by the type and composition of substrates and inks used. Please note that the use of substrates and inks that differ from those defined at the time of purchase may influence the performance of the machine. Please also note that options and special features of the machines may influence the performance and might change dimensions, cycle times and application possibilities compared to the standard version.

## table screen printing machine

3050		3060		3070	
100 x 1800	55 x 71	1550 x 2100	61 x 83	1550 x 2600	61 x 102
120 x 1860	56 x 73	1570 x 2160	62 x 85	1570 x 2660	62 x 105
130 x 1870	56 x 74	1580 x 2170	62 x 85	1580 x 2670	62 x 105
150 x 2200	74,8 x 86,6	2050 x 2500	80,7 x 98,4	2050 x 3200	80,7 x 125,9
150 x 2100	65 x 83	1800 x 2400	71 x 94	1800 x 2900	71 x 114
110 x 1860	56 x 73	1560 x 2160	61 x 85	1560 x 2660	61 x 105
50	2	50	2	50	2
+/- 5	+/- 0,2	+/- 5	+/- 0,2	+/- 5	+/- 0,2
0,2-1,4	8-55	0,2-1,4	8-55	0,2-1,4	8-55
1900	4189	2100	4636	2400	5298
570		500		500	
400 / 230		400 / 230		400 / 230	
2,8		2,8		2,8	

ject to change

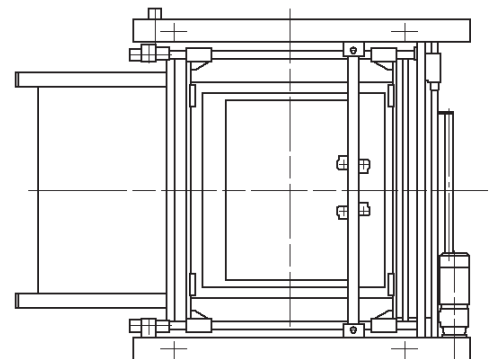
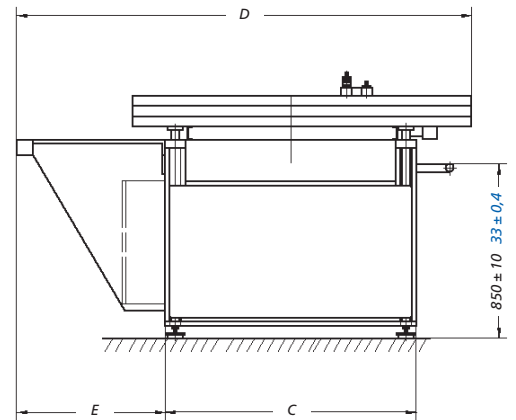
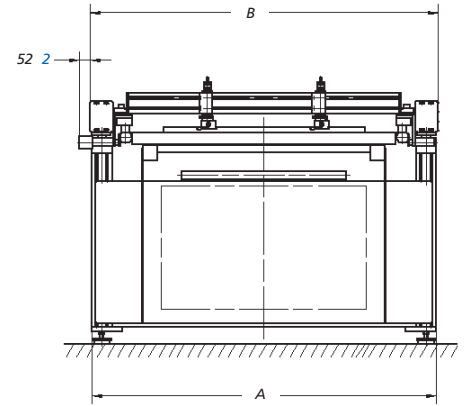

### Dimensions (mm inch)

Type	3010	3020	3030	3040	3050	3060	3070
A	1680 66	1980 78	2330 92	2580 102	2780 109	3080 121	3680 145
B	1680 66	1980 78	2330 92	2580 102	2780 109	3080 121	3680 145
C	1225 48	1425 56	1675 66	1925 76	2125 84	2275 90	2275 90
D	2225 88	2625 103	3125 123	3575 141	3975 156	4275 168	4310 170
E	725 29	925 36	1175 46	1375 54	1575 62	1725 68	1725 68



#### **THIEME 3000**

**3/4-automatic, flatbed, shuttle table screen printing machine.**

**The result of vast experience in graphic and industrial screen printing.**

**The flexibility to handle a wide range of substrates up to 50 mm (2") thickness.**

**User-friendly construction, excellent production quality, high printing performance and silent running are proven features of this advanced machine design.**

- **Self-adjusting squeegee unit**
- **Quick fixation system of screen frame**
- **Electronic control with user-friendly, intelligent software**

**The standard equipment of the THIEME 3000 is designed with modern screen printing in mind. Print economics and repeatability are synonymous with this precision machine.**

**For special requirements a wide range of accessories and options are available, and tailor-made for your needs.**

**Banners, POP signage and displays, can be printed efficiently and profitably in excellent print quality on the THIEME 3000.**

For more information,  
please contact  
your local branch or  
our head office.

Hauptsitz Deutschland/  
Head office Germany:  
THIEME GmbH & Co. KG  
Robert-Bosch-Straße 1  
79331 Teningen

Tel. +49 (0) 76 41-583-0  
Fax +49 (0) 76 41-583-110  
E-Mail: [info@thieme-products.com](mailto:info@thieme-products.com)

France:  
THIEME S.A.S.  
„Les Scientifiques“  
Rue Sébastien Brant  
Parc d'Innovation  
B.P. 50311  
F-67400 Illkirch

Tél. +33 (0) 3 88 55 27 00  
Fax +33 (0) 3 88 67 33 13  
E-Mail: [thieme.fr@wanadoo.fr](mailto:thieme.fr@wanadoo.fr)

USA:  
THIEME Corporation  
3605 Swenson Avenue  
St. Charles, IL 60174

Phone +1-630-513-1666  
Fax +1-630-513-1999  
E-Mail: [info@thieme-us.com](mailto:info@thieme-us.com)

member of 

Great Britain:  
THIEME KPX Ltd.  
Upper Bankfield Mills  
Almondbury Bank  
Huddersfield HD5 8HF  
West Yorkshire, England

Tel. +44 (0) 14 84 51 13 33  
Fax +44 (0) 14 84 54 17 99  
E-Mail: [sales@thiemekpx.co.uk](mailto:sales@thiemekpx.co.uk)