

# SENFENG

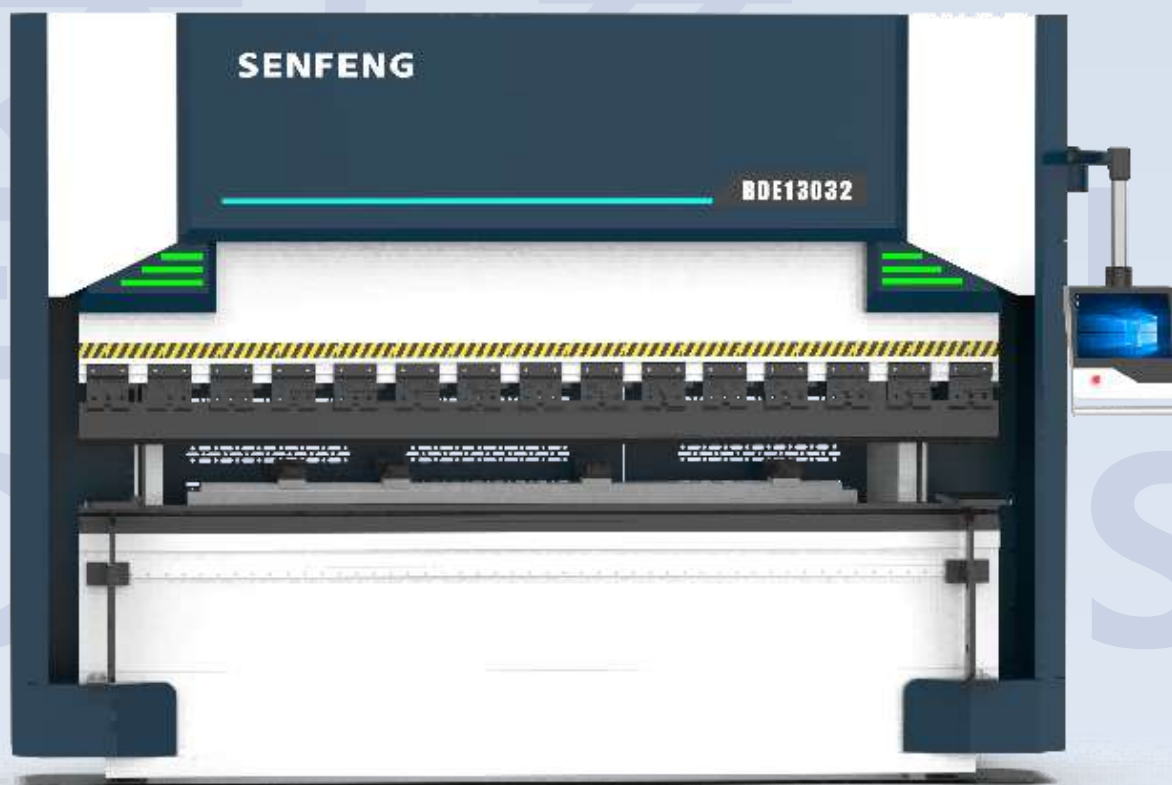

# BDE13032

## Press Brake

Specifications: 3200 mm x 130 tons

DELEM DA66S CNC system, 6+1 axis control, Y1, Y2, X, R, Z1,Z2 axis, standard CNC

Deflection compensation function

# BDE13032

6+1-66S

The SENFENG CNC press brake, based on a proven traditional design, offers enhanced speed, stroke, opening height, and pressure compared to others. It features high precision, efficiency, stability, and ease of use.

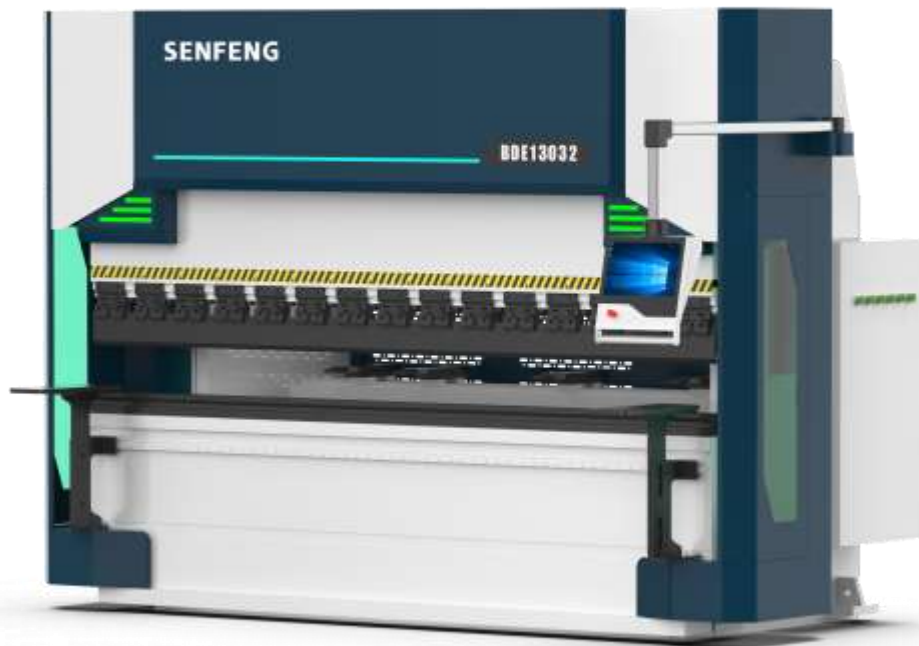

## The following parts are included

- Hybrid energy-saving function (Below 170T)
- Standard domestic Lane LPD-A light curtain, optional imported DSP light curtain
- Working area equipped with LED lighting
- Compensation workbench with mold base guide rail
- Sliding front support with full-length linear guide rail
- Additional control panel with smart factory LAN (optional)
- Hydraulic oil cooling device standard for equipment above 200T

※All images are for illustrative purposes only. The actual product appearance and dimensions may vary based on the final factory delivery.

# Technical Parameters

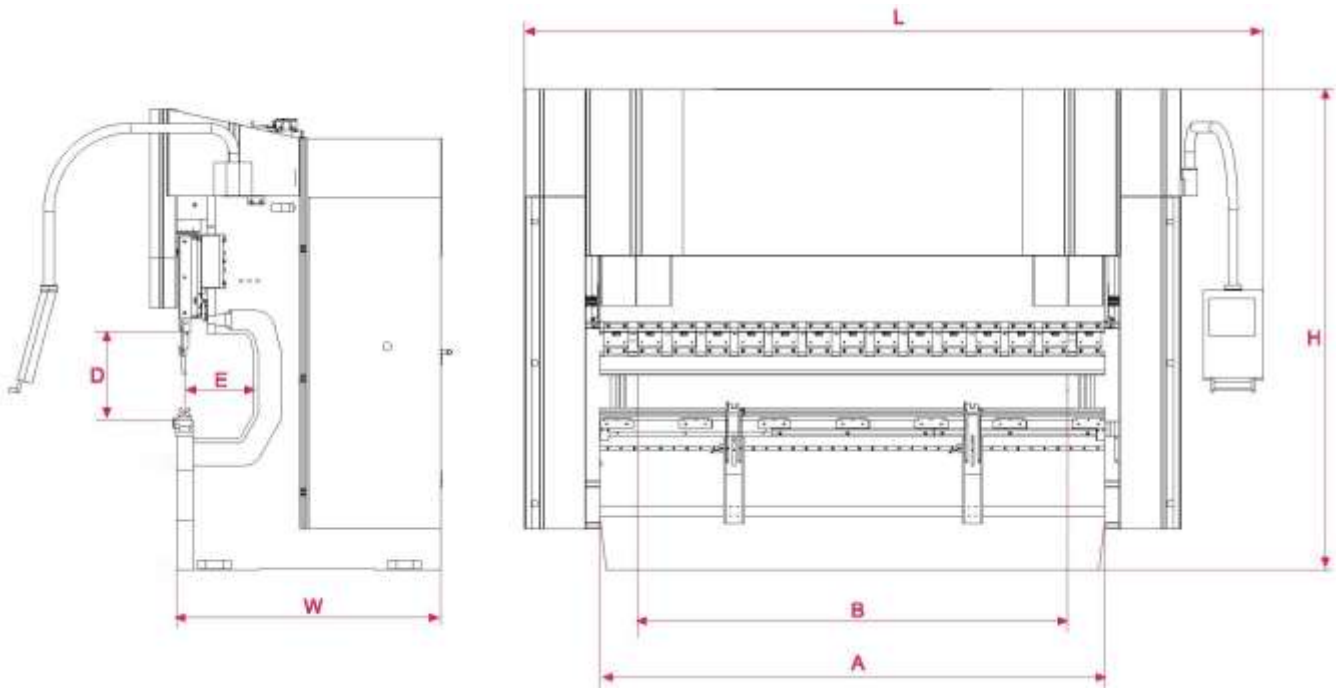

Model	BDE13032
Nominal pressure	1300KN
Workbench length (A)	3200mm
Column spacing (B)	2600mm
Throat Depth (E)	400mm
Slider stroke	200mm
Opening height (D)	480mm
Size	3700*1515*2630 (L*W*H)

# Technical Parameters

Model	BDE13032	
CNC Axis	Y1-Y2-X-R-Z1-Z2-V (6+1 axis)	
Slider running speed	quickly	180mm/s
	working	0-10mm/s
	Return	160mm/s
X axis (back gauge)	Travel	480mm
	Maximum operating speed	400mm/s
Main servo motor	10.8kw	
Machine weight	8120kg	
Bending thickness (Note: calculated by bending length of 3200mm)	≤4.5 mm carbon steel ≤ 3 mm stainless steel ≤ 7 mm aluminum	
Bending Accuracy		
Consistent bending angle accuracy over full length	±30'(1° = 60') (carbon steel for example)	
Full-length straightness accuracy	±0.15mm (carbon steel for example)	
Overall bending length dimension	±0.15mm	
X-axis speed	400mm/s	
X-axis accuracy	±0.02mm	
R-axis speed	200mm/s	
R-axis accuracy	±0.05mm	

# Main Configuration

Item	Brand
CNC System	DELEM-6+1-66S
Hydraulic control system	REXROTH
Oil Pump	HYTEK
Main motor	INOVANCE/ESTUN
Magnetic scale	SENTEK/GIVI
Transmission part	HIWIN
Cylinder seal original	SKF
Main electrical parts	SCHNEIDER
Compression fittings	EMB
Deflection compensation	HuangShi
Laser protection	LNTECH

# Machine bed

Our machine bed is made of Q235B steel, while most other manufacturers typically use standard Q235A carbon steel. SENFENG adopts a mortise-and-tenon (embedded) welding structure, ensuring greater welding strength. The machine bed offers high stability and precision. Both the frame and the ram are processed in one piece using a large high-precision floor-type boring and milling machine. The ram undergoes integral vertical machining to prevent deformation and rebound after processing.

1

## Superior material performance

Q235B steel has better toughness and impact resistance. When subjected to heavy pressure, the Q235B steel bed is not easy to break, which extends the service life of the bed and ensures long-term stability.

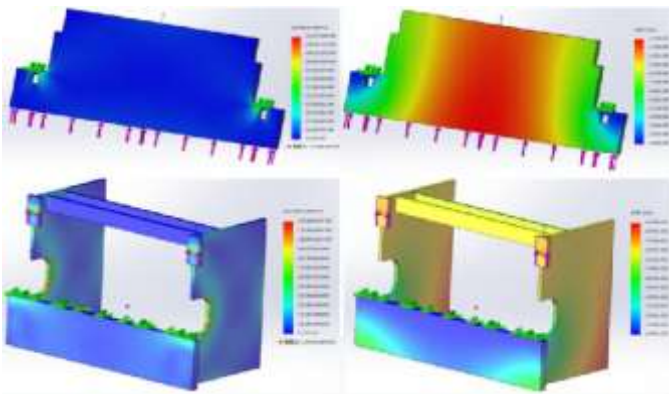

3

## Prevent deformation rebound

The slider adopts integral vertical processing, which optimizes the processing stress distribution and effectively prevents deformation and rebound after processing. It ensures that the flatness, verticality and other geometric tolerances of the slider meet high-precision standards and improves the overall accuracy of the bed.



2

## Exquisite welding technology

Mortise and tenon (embedded) welding increases the welding contact area. The welding strength is greatly improved, the bed structure is more stable, and it will not loosen due to vibration during daily use.





## 4. Overall processing advantages

The frame and slide are processed as a whole at one time, avoiding positioning errors caused by multiple clamping. The matching accuracy of the various parts of the bed is higher, the operation is more stable, and there will be no problem of accuracy reduction due to improper matching of parts in long-term use.

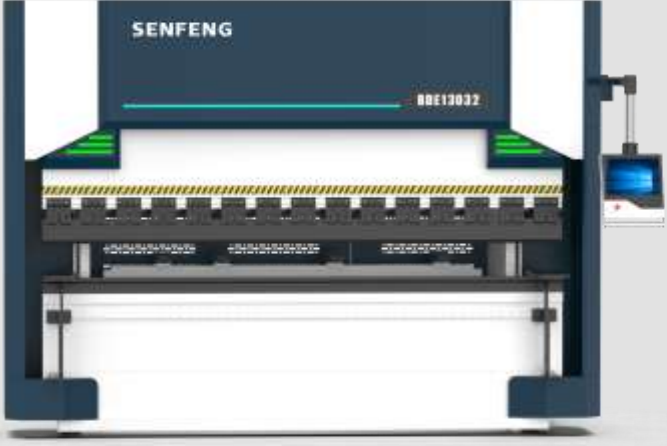

# Axis number indication

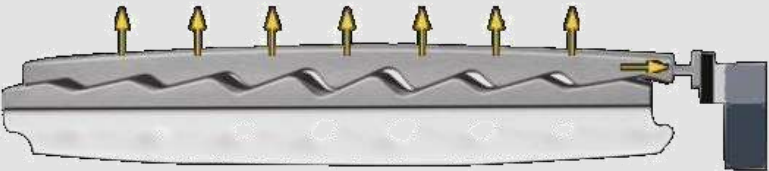
Y1-Y2-X-R-Z1-Z2+V	Sketch Map
Y1-axis	
Y2-axis	
X-axis	
R-axis	
Z1-axis	
Z2-axis	
V-axis	

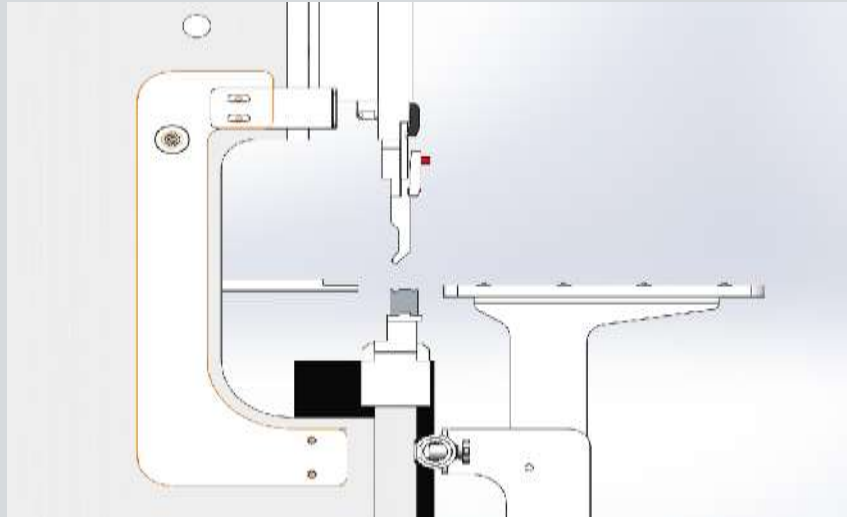

- The machine's throat depth can be customized, offering ample space for a wide range of bending operations.
- It comes equipped with European-style upper and lower dies as standard.
- The opening height is also customizable, representing an innovative advancement in the field of bending machines.
- A universal crowning workbench is included as standard.
- Optional features include VERA hydraulic upper and lower clamps and double-sided quick clamps.

## Deflection compensation workbench

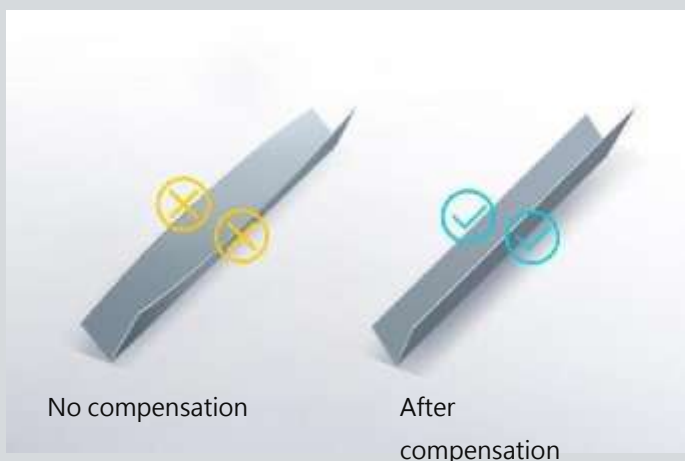

■ Ideal compensation    ■ Actual compensation

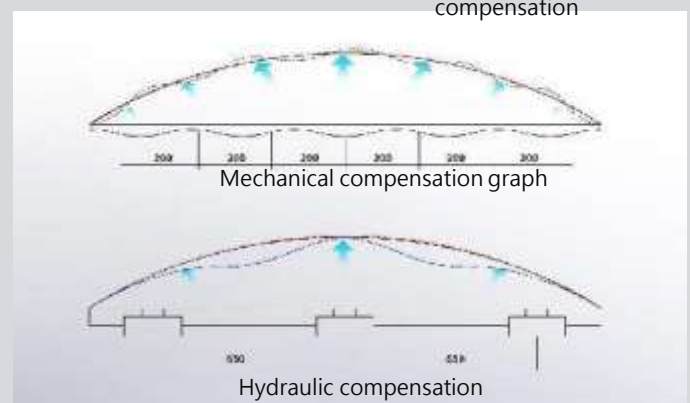

- It consists of uniquely processed and heat-treated wedges. Each set is designed to compensate for the deformation of the upper and lower beams during operation. The CNC system calculates the required compensation based on the bending load and automatically adjusts the wedges to effectively correct beam deflection and deformation.

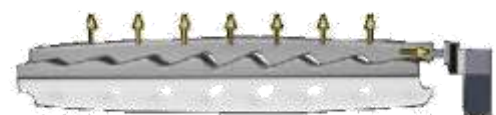

# Optional DSP safety light curtain



## DSP laser safety protection device

DSP laser safety protection device fully guarantees the personal safety of the bending machine operator and avoids the danger caused by the rapid movement of the slide on the machine tool. The bending tool tip forms a block protection area to protect the front, middle and back areas of the tool tip.

- CLASS 1M block laser transmitter
- Safety level reaches CAT. 4 and SIL3
- Complies with European CE certification
- Protection level IP65
- System response time is 5MS
- With stop distance detection function
- Can manually adjust the shielding point at will, easy to set up, and provide continuous monitoring

# DELEM DA66S

Dutch DELEM-DA66S CNC system: It integrates the most advanced functions of bending machine control, which can significantly improve production efficiency. It not only provides high-precision control, but also provides operators with an unprecedented convenient operation and programming experience. It has become an indispensable part of the entire production chain.

Based on the most advanced industrial touch screen technology, the updated user program interface can be easily accessed. It can directly navigate and switch between product programming and actual production. The main function buttons are directly configured where they are needed, providing optimized ergonomic design for the entire application operation



## DA-66S Features

- 2D touch graphic programming
- 3D product graphic simulation display
- 24" high-resolution color TFT display Delem module compatible (module expandable and adaptive)
- USB, peripheral interface supports Industry 4.0 interface (OPC-UA option)
- Workshop control, work list function ·Open system architecture
- Angle detection bending & angle correction interface
- Profile-SL offline programming software

# Optional WILA new standard clamping system

## 1 Improve production efficiency

- Wila's "New Standard" tooling system has become a market leader in press brakes. WILA's advanced clamping system, combined with the Smart Tool Locator® (STL)\*, offers the option for ultra-efficient tool changes, which makes the tool change process easier and safer. Premium is available as an option.



## 2 Intelligent tool positioner® (STL) Optional

- Improve your bending machine's productivity
- The Smart Tool Locator (STL) can further improve your bending machine's productivity. During tool installation, the system indicates the correct clamping position of the tool through a built-in LED light and displays the tool position in use in production mode.
- The Smart Tool Locator offers significant advantages in terms of speed, precision and flexibility.



### Features

- Adopt hydraulic power source;
- Suitable for quick clamping of European molds
- Clamping can be completed with a simple button operation;
- The maximum load capacity of the cutter head/shoulder is 180 tons/meter;

# Tool Rack New Standard Pro

The WILA® system allows the user to compensate for the deformation of the crossbar during the bending process. As a result, the bending angle remains constant over the entire length of the sheet.

### Standard

- Tool slot CNC-Dee-phardened®
- Drive unit CNC, motor at one end
- Designed for press brakes, UPB-II hole pattern

### Optional

- Smart Tool Locator® (STL)\*
- Drive unit CNC, motor fully integrated
- WILA CNC crown adjustment



### Features

- Tool can be easily reversed
- Hydraulic clamping
- Quick clamping mold

# European standard mold

## Improve the productivity of your bending machine

All raw materials used by SENFENG are provided by qualified suppliers and their chemical composition complies with international standards. Therefore, the yield strength and tensile strength of the raw materials are guaranteed. The mold is equipped with a standardized safety groove of 8.4 x 3.5 mm to prevent the tool from falling.

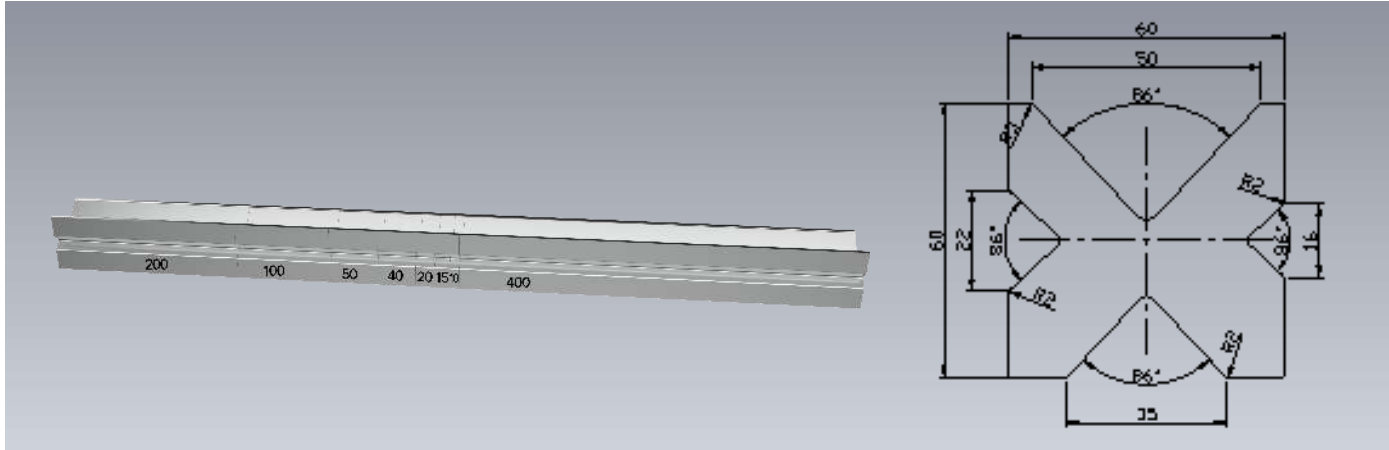
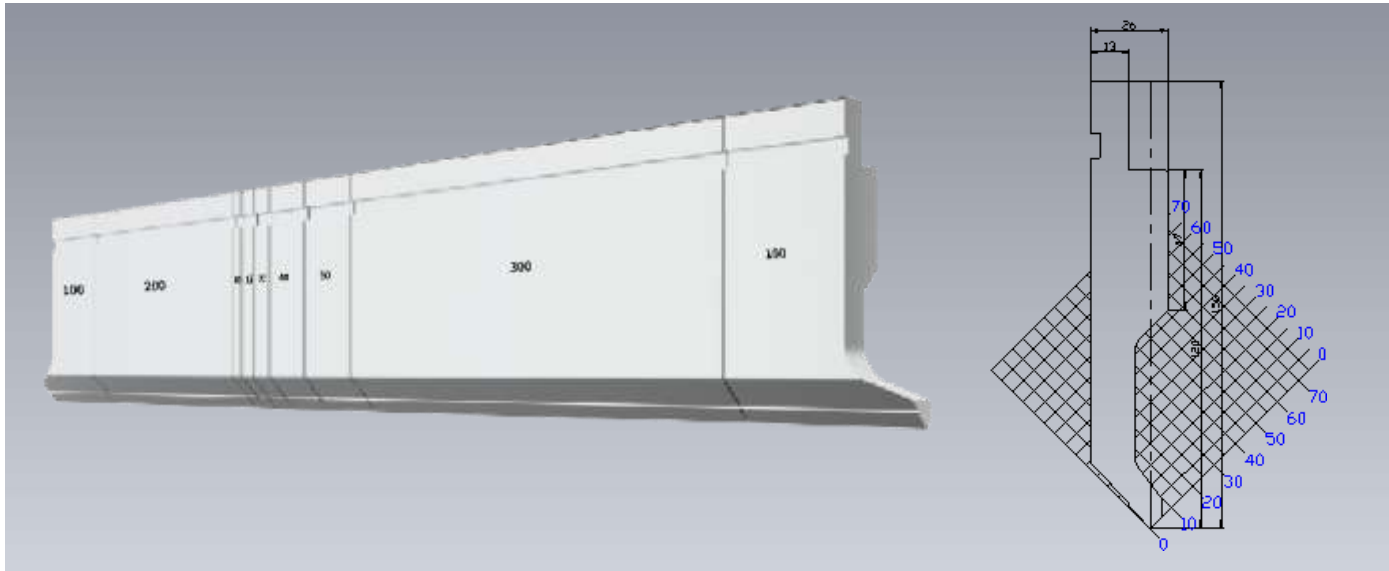

# New hybrid ecological function

This is a set of customer-oriented innovative solutions to reduce the energy consumption of machines. SENFENG promotes environmental protection policies, therefore, all our equipment has hybrid ecological functions.

- This hybrid servo drive system achieves positioning accuracy at the target position.
- Depending on the cycle characteristics and ratings, servo pump drives can achieve energy savings.

## Features

- Lower energy consumption
- Significantly lower noise levels
- Significantly lower cooling power consumption, 28.8 kW per hour
- More than 30% fuel savings
- Higher operating speeds
- Greater flexibility

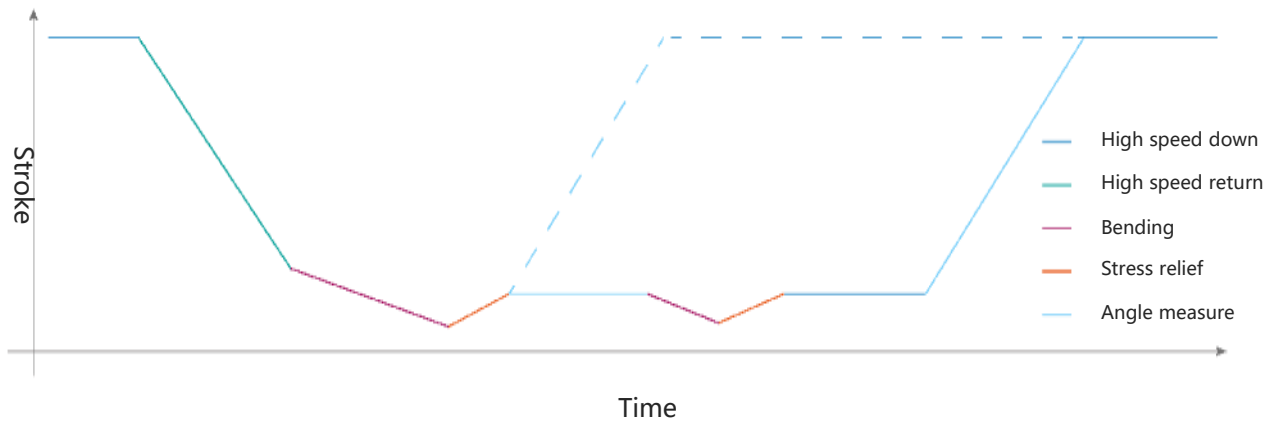
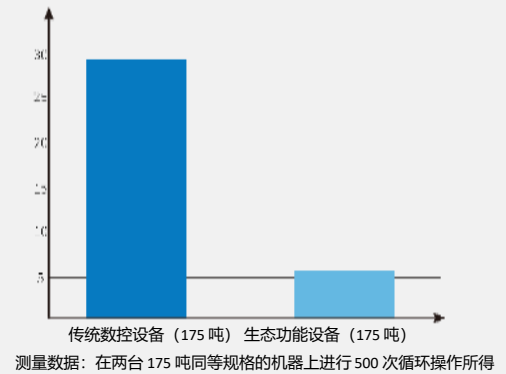

## Customer Benefits

- High dynamic performance enables the machine to achieve higher production efficiency.
- Complies with EU directive requirements.
- Lower energy consumption, creating a green and environmentally friendly machine.
- Sound pressure level is reduced to 50 decibels.
- Equipped with servo motors with closed-loop speed control.
- Energy efficiency is improved by up to 35% compared to traditional systems.
- Due to low energy consumption, operating costs are minimized. Therefore, it brings users the advantages of high efficiency and low operating costs.

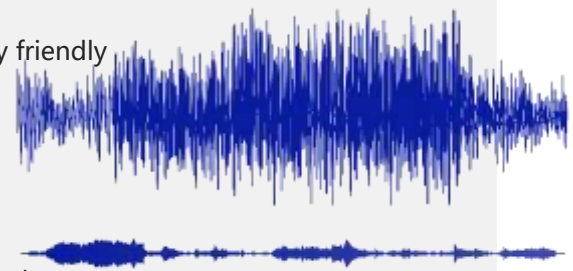

## Providing Global Users with Automated Metal Fabrication Solutions

SENFENG provides automated metal fabrication solutions globally, integrating cutting, bending, welding, cladding, automation, and new energy. With core technologies in laser cutting, welding, and cladding, the company also offers intelligent manufacturing systems like flexible laser processing lines and sheet metal bending centers. These solutions serve industries including automotive, construction, energy, and petrochemicals, and are used in over 100 countries.



# 03

International PCT Patents

# 577

Chinese technology patents

SENFENG has developed key components like laser generators, processing heads, Feng Cloud systems, and CNC systems, used in cutting, welding, cladding, and automation. The company offers a complete industry chain, including laser cutting, welding, cladding, cleaning machines, bending centers, and flexible production lines. These solutions are used in sectors like power towers, construction machinery, shipbuilding, bridges, and aerospace, helping businesses accelerate production and reduce costs for greater economic benefits.

# SENFENG

## 5-star Fast Service

### Efficient

- Our repair hotline is available 24/7.
- A professional engineer will respond to customer inquiries within 10 minutes and provide a repair plan within 1 hour.



### Professional

- **Custom Service:** Tailored service plans based on the specific needs of the customer.
- **Service Engineer Certification System:** Each service engineer undergoes rigorous training and assessment before being certified to work.
- **Common Issues Training:** Create a manual for common issues based on equipment models, with certified engineers providing customer training.
- **Online Guidance:** Experienced senior engineers offer support through phone or video calls to help customers resolve issues.
- **Professional Technical Support:** The equipment is properly calibrated during the first installation, and similar issues are resolved in one go.



### Comprehensive

- **Pre-service:** Theoretical and hands-on operation training, common fault self-diagnosis training, quick repair guidance for troubleshooting, usage reminders.
- **Regular Service:** Regular maintenance reminders, on-site services, periodic promotional activities.
- **Value-added Service:** Equipment software and hardware upgrades, financing lease services, extended warranty services.



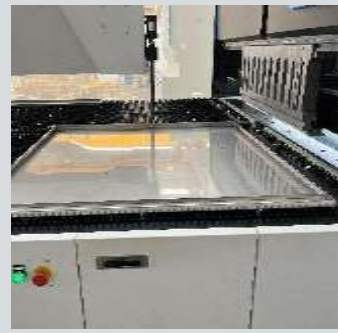
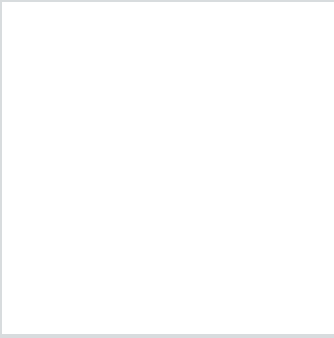

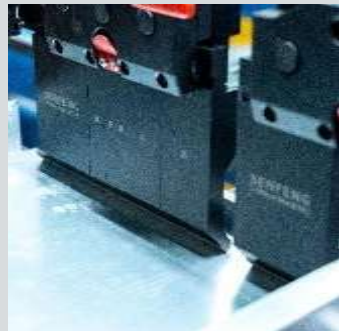

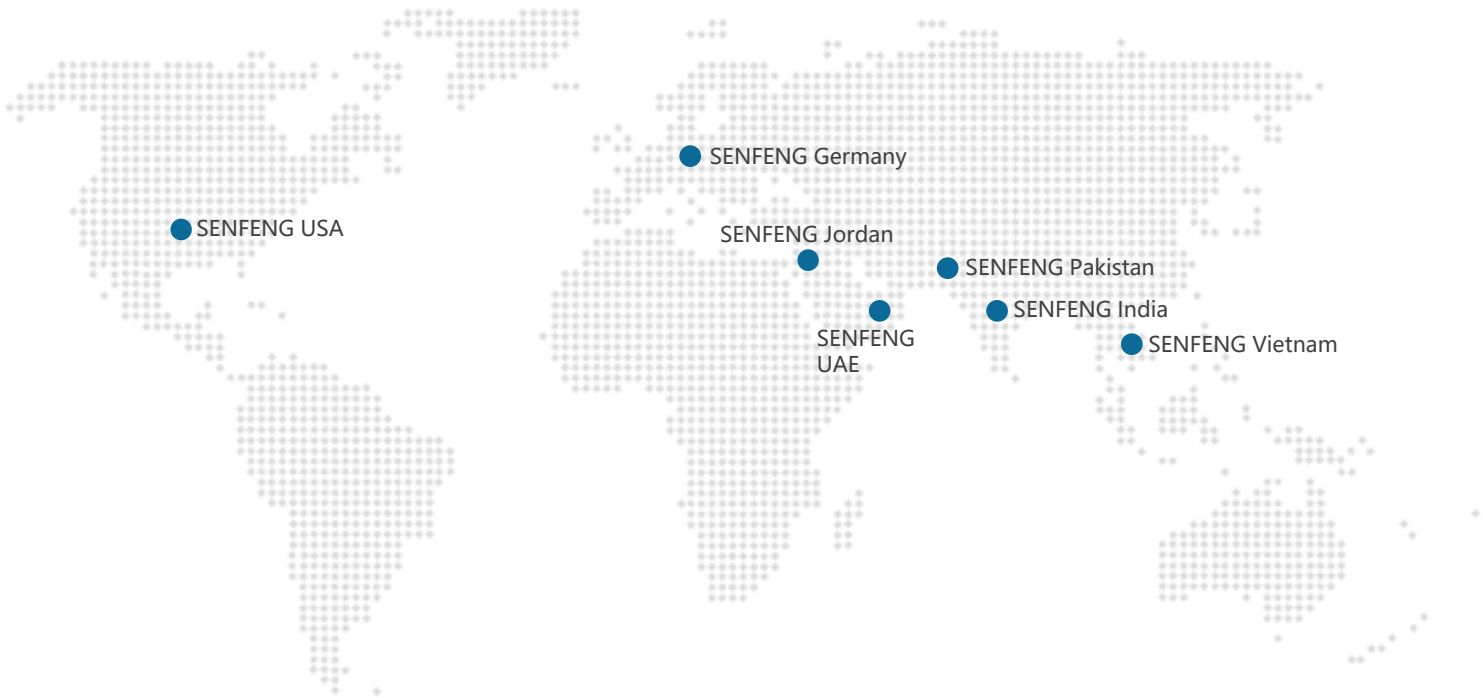

## Senfeng CNC Laser Germany GmbH

E-mail: [info@sflaser.de](mailto:info@sflaser.de)

Tel: +49 173 8711059

Website: [de.senfenglaser.com](http://de.senfenglaser.com)

Add: Waldstraße 76A, 63128 Dietzenbach, Deutschland