

EUROPROFILI ART. 1850  
(Terminali TE 1855/G)  
ROVERPLASTIK AL 180

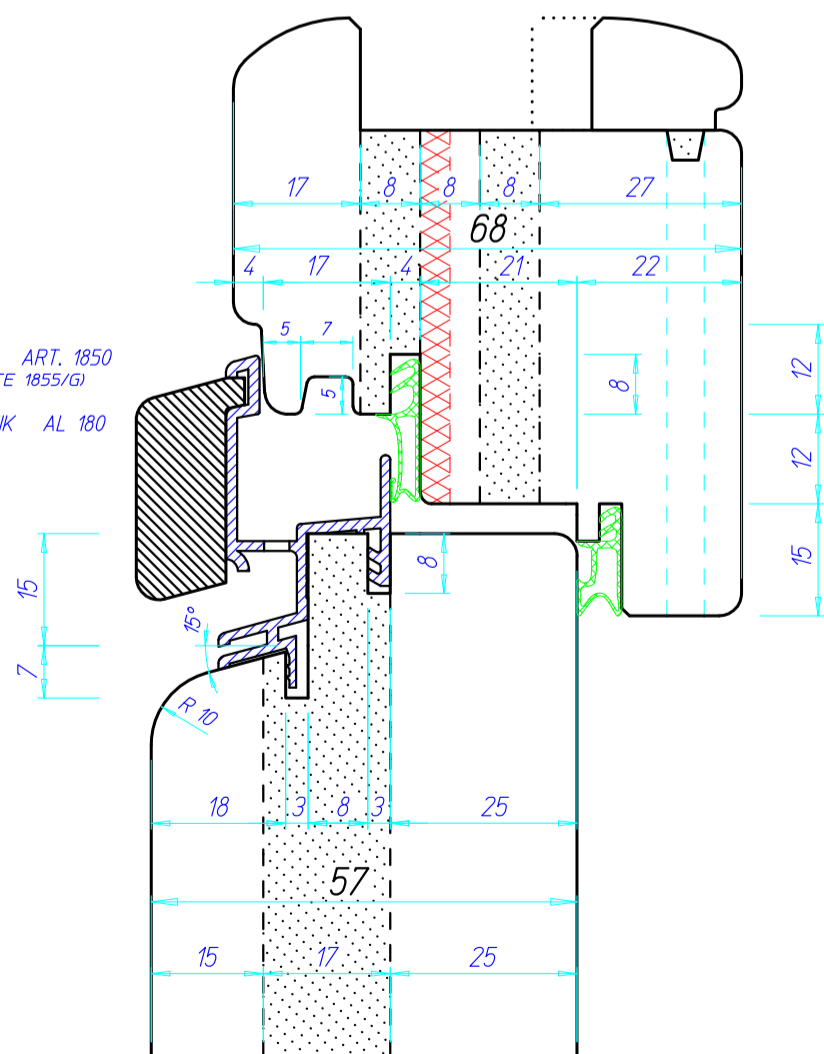

Via dell'Artigiano, 57 (Z.I.) - 38068 Rovereto (TN) Italy  
Tel. 0039 (0)464 433183 Fax 436316  
Web: www.zuani.it E-Mail: info@zuani.it

Titolo				
TIELLE < BARGERRO >				
Infisso sp. 68 mm. - 2 guarnizioni				
Revis.	Data	Scala	Dis.	Data
		1:1	Pa	2-06-99
Verif.	Data	Cod. Dis.N°		
Pa	9-06-99	1595.99.02		

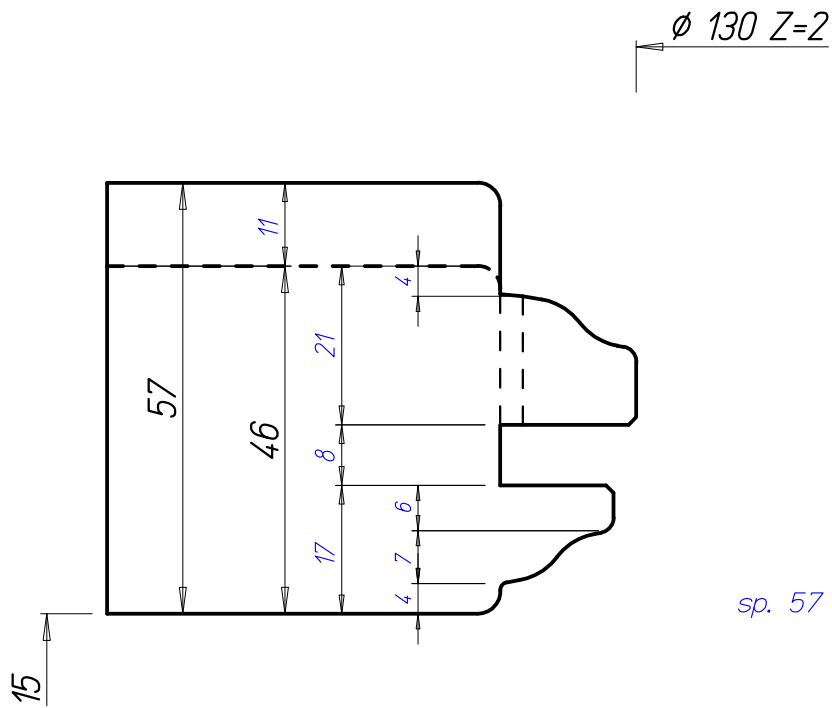

sp. 57 mm. VETRO 19 mm.

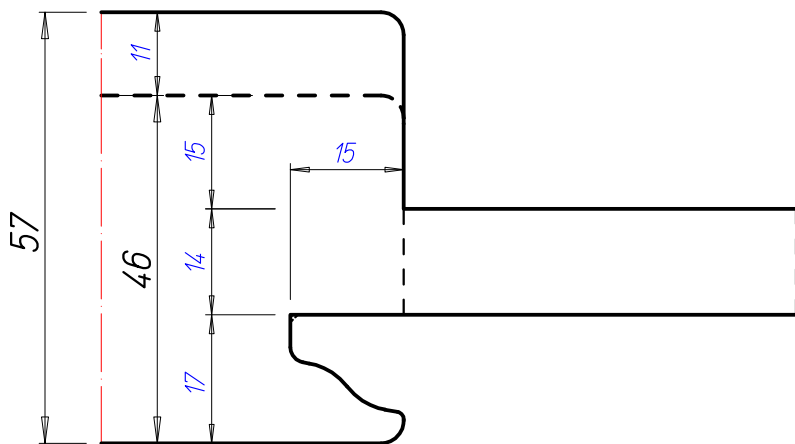

**ZUANI**

Via dell'Artigiano, 57 (Z.I.) - 38068 Rovereto (TN) Italy  
 Tel. 0039 0464 433183 Fax 436316  
 Web: www.zuani.it E-Mail: info@zuani.it

Titolo <b>TIELLE &lt; BARGERIO &gt;</b>				
PORTA - PORTONCINO				
Revis.	Data	Scala	Dis.	Data
		1:1	Pa	08-06-99
Verif.	Data	Cod.	Dis.N°	
Pa	8-06-99	1595.99.03		

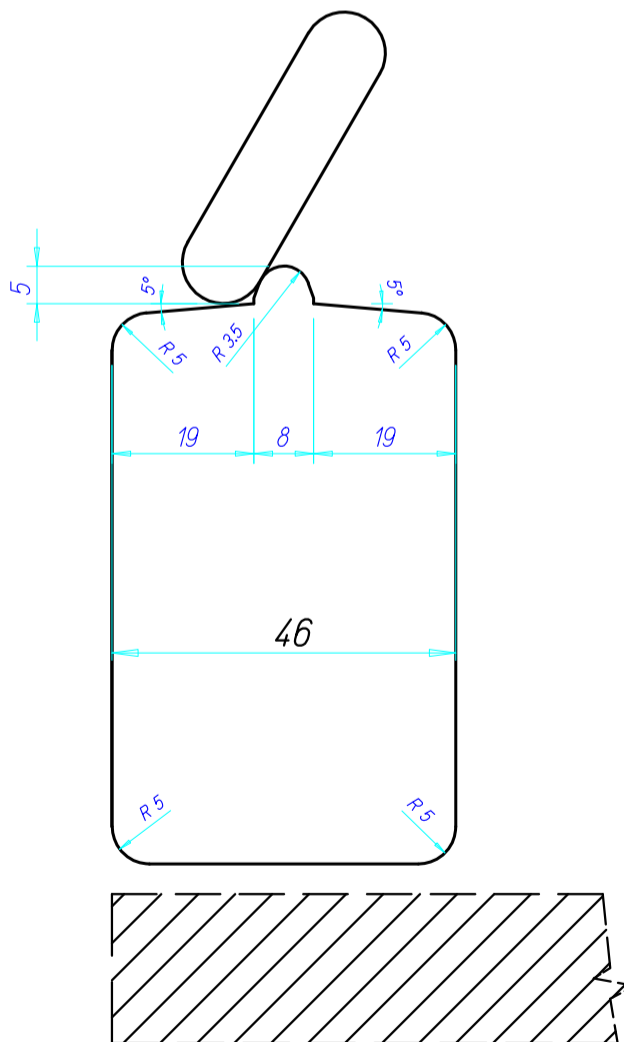
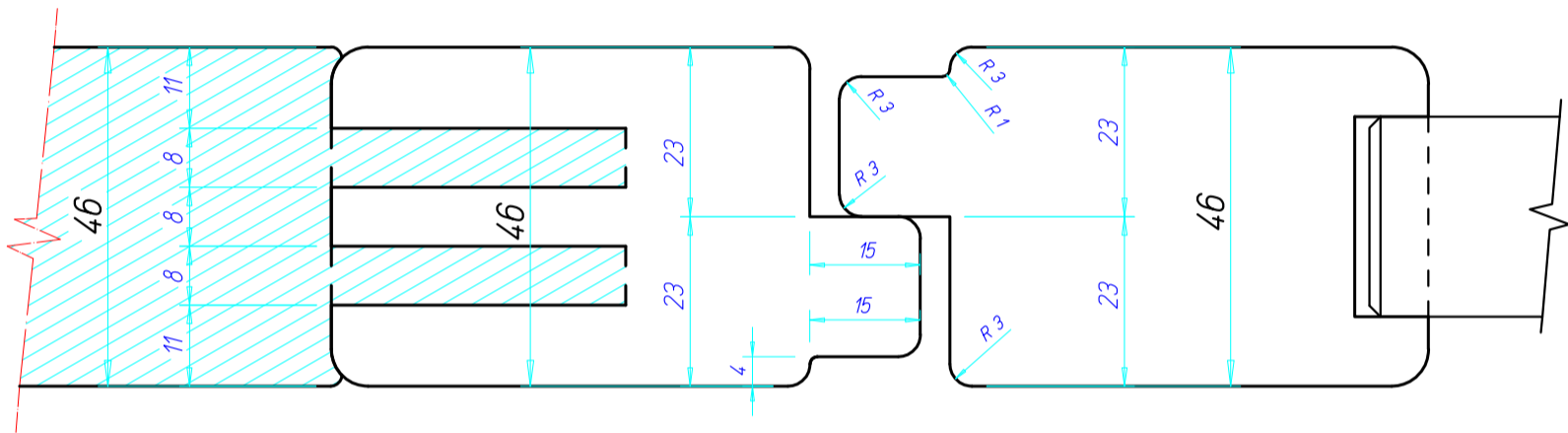
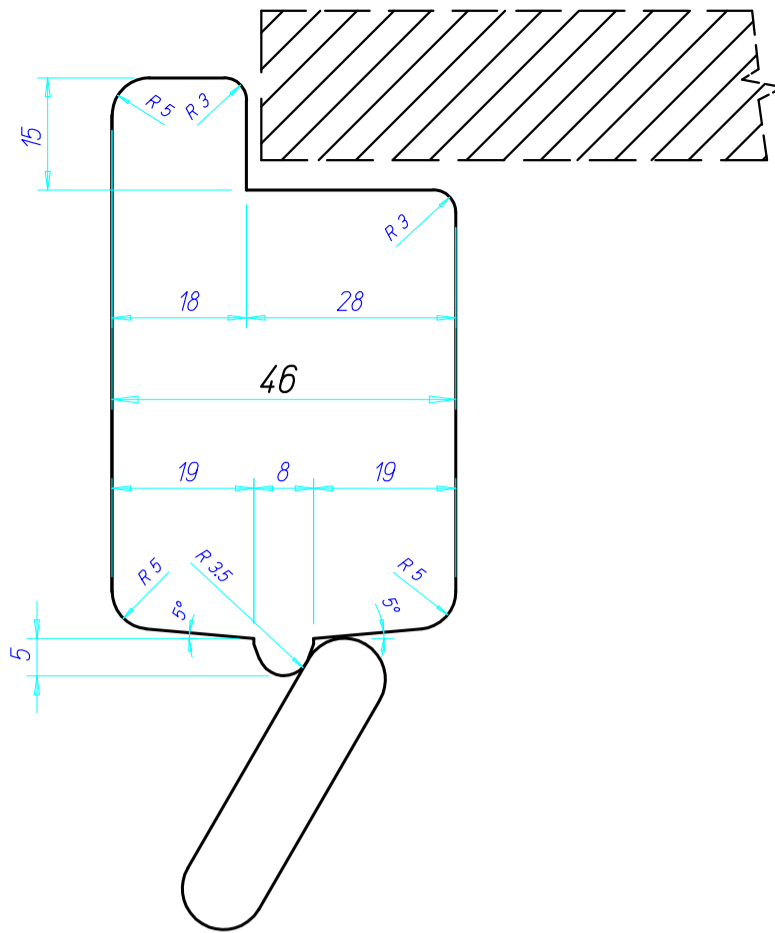

**ZUANI** 

Via dell'Artigiano, 57 (Z.I.) - 38068 Rovereto (TN) Italy  
 Tel. 0039 0464 433183 Fax 436316  
 Web: www.zuani.it E-Mail: info@zuani.it

N.B. : Misure dei pezzi  
DOPO CALIBRATURA !

Titolo						TIELLE < BARGERRO >					
						PERSIANA sp. 46 mm.					
Revis.		Data		Scala	1:1	Dis.	Pa	Data	2-06-99		
Verif.	Pa	Data	10-06-99	Cod. Dis. N°					1595.99.04		



*PERSIANA*  
Squadratura traverso  
inferiore  
(Int. a tempo)  
SB1595.99.013

265

*PERSIANA*  
Squadratura montanti  
e traverso superiore  
(Int. a tempo)  
SB1595.99.012

199

*BATTENTE*  
Squadratura montanti  
e traversi  
(Int. a tempo)  
SB1595.99.011

123

119

*BATTENTE*  
Esecuzione sede  
ferramenta DREH-KIPP  
SB1595.99.010

46

42

*TELAIO*  
Profilatura montanti e  
traverso superiore  
SB1595.99.009

6

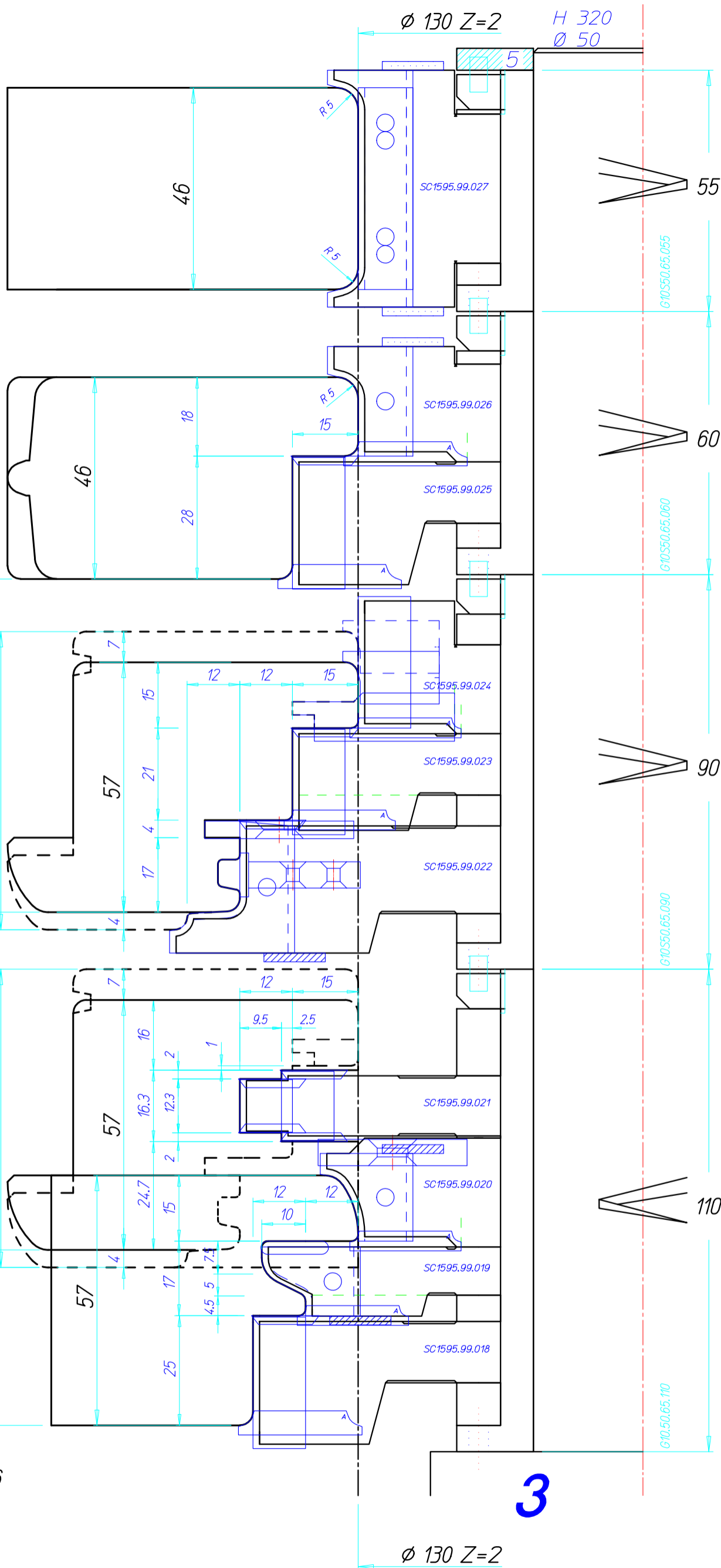



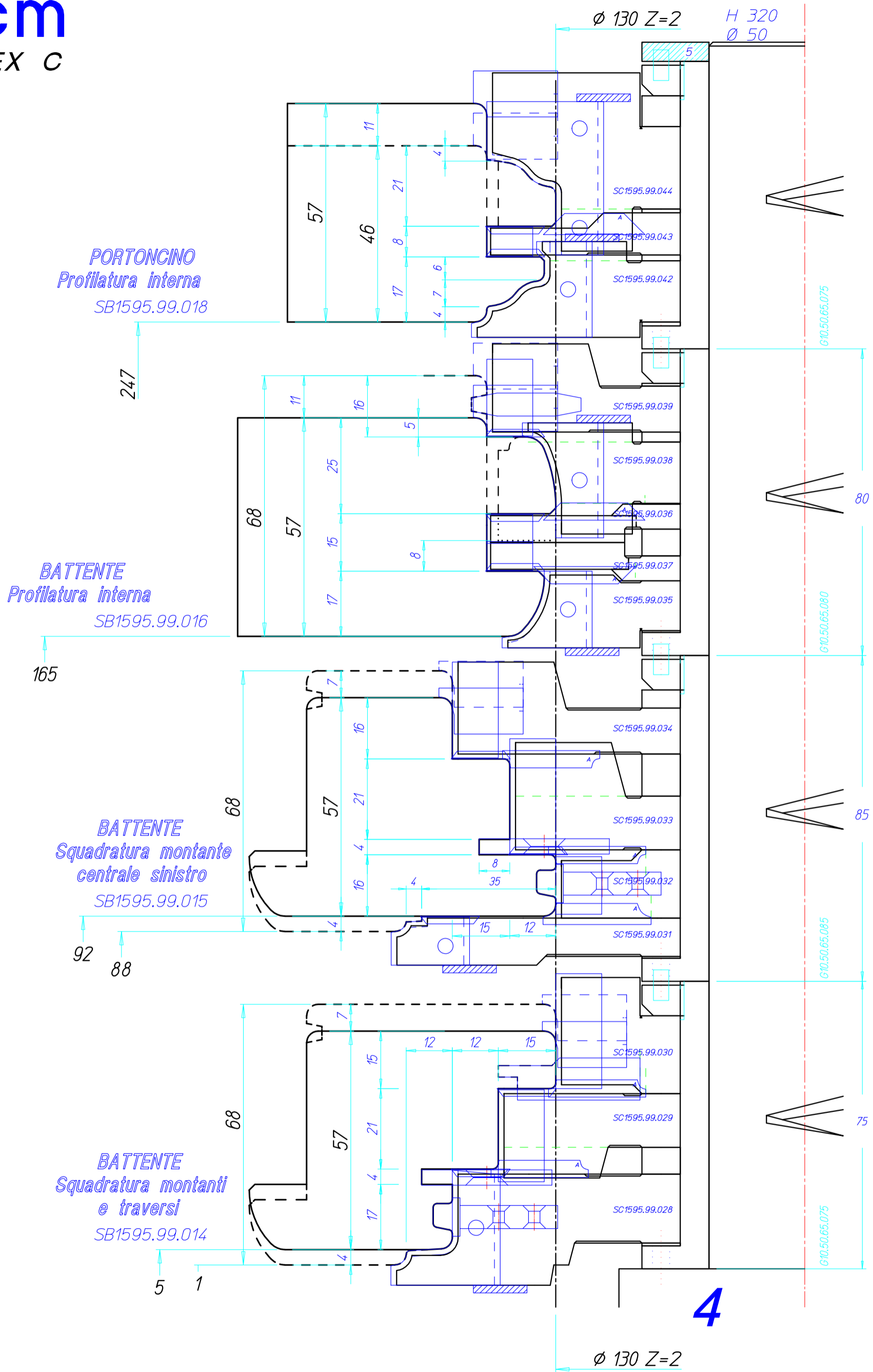

PORTONCINO  
Profilatura interna  
SB1595.99.018

BATTENTE  
Profilatura interna  
SB1595.99.016

BATTENTE  
Squadratura montante  
centrale sinistro  
SB1595.99.015

BATTENTE  
Squadratura montanti  
e traversi  
SB1595.99.014

Titolo <b>TIELLE &lt; BARGERO &gt;</b>					
CAMBIO per PROFILATURA PORTONCINO					
Revis.	Data	Scala	Dis.	Data	
		1:1	C.B.	15-06-99	
Verif.	Data	Cod. Dis. N°			
C.B.	16-06-99	1595.99.4			

*PERSIANA*  
Squadratura montanti  
centrali  
SB1595.99.022

264

*PERSIANA*  
Squadratura montanti  
e traverso superiore  
SB1595.99.021

202

*PERSIANA*  
Profilatura montanti  
Squadratura traverso  
inferiore  
SB1595.99.020

147

*PERSIANA*  
Profilatura traversi  
SB1595.99.019

86

*BATTENTE*  
Squadratura montanti  
e traversi  
SB1595.99.014

5  
1

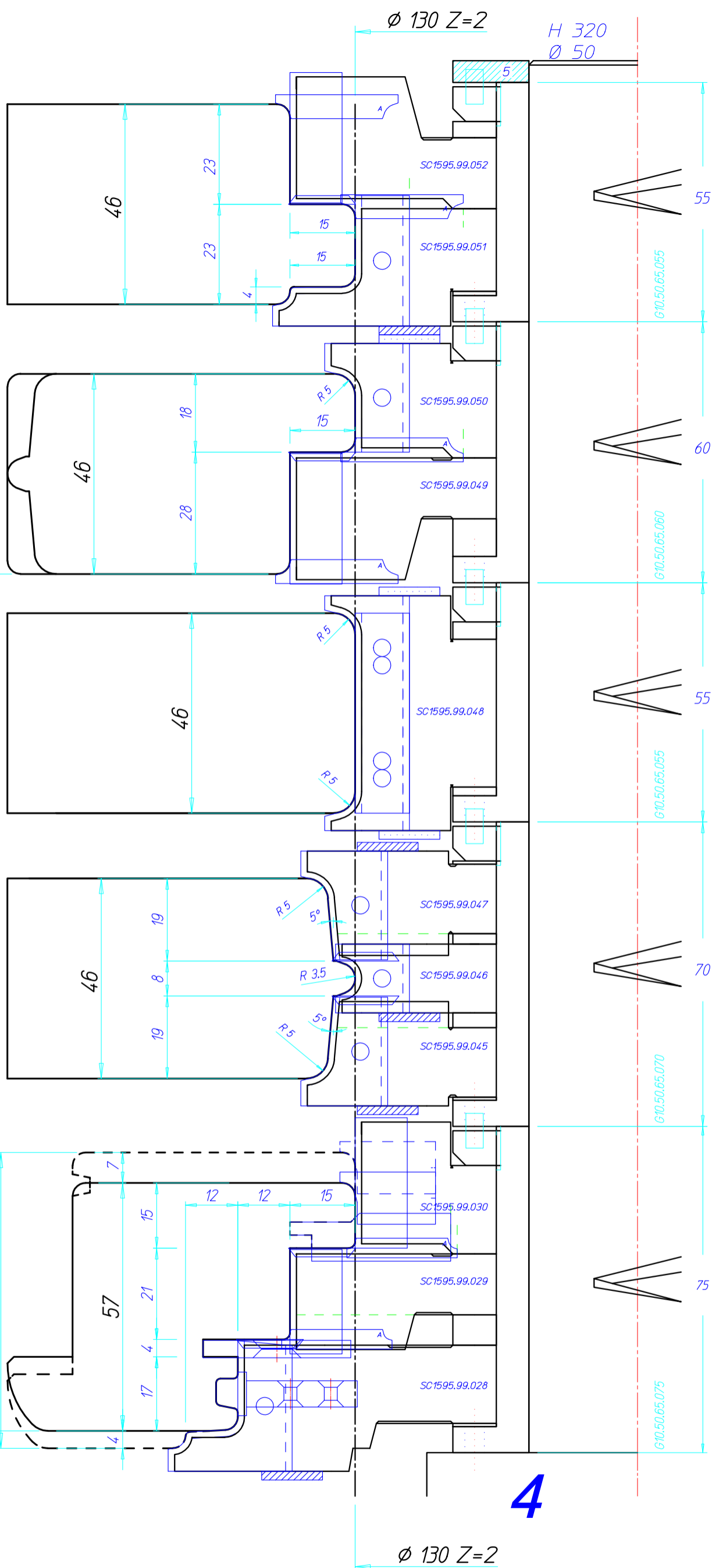

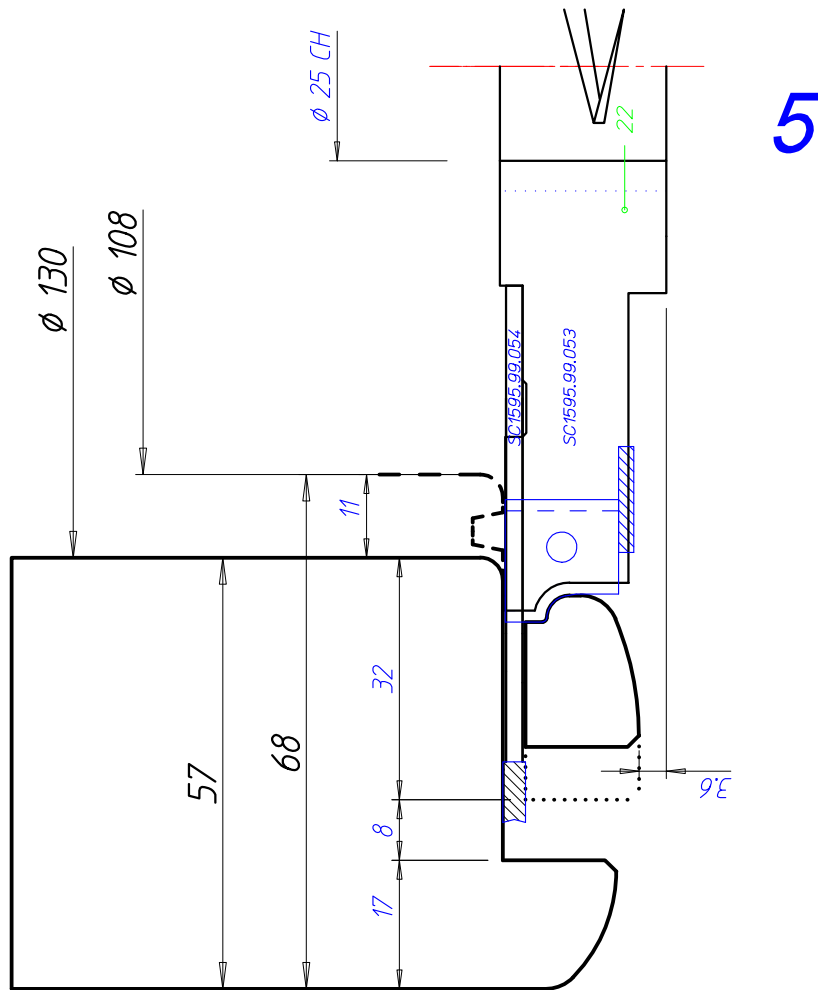

*BATTENTE*  
*Recupero listello*  
*fermavetro*  
SB1595.99.023

Titolo <i>TIELLE &lt; BARGERIO &gt;</i>					
<i>Recupero listello</i>					
Revis.	Data	Scala	Dis.	Data	
		1:1	C.B.	16-06-99	
Verif.	Data	Cod.	Dis.N°		
C.B.	16-06-99	1595.99.6			