

WSAB LIGNOMAT

WSAB Lignomat GmbH

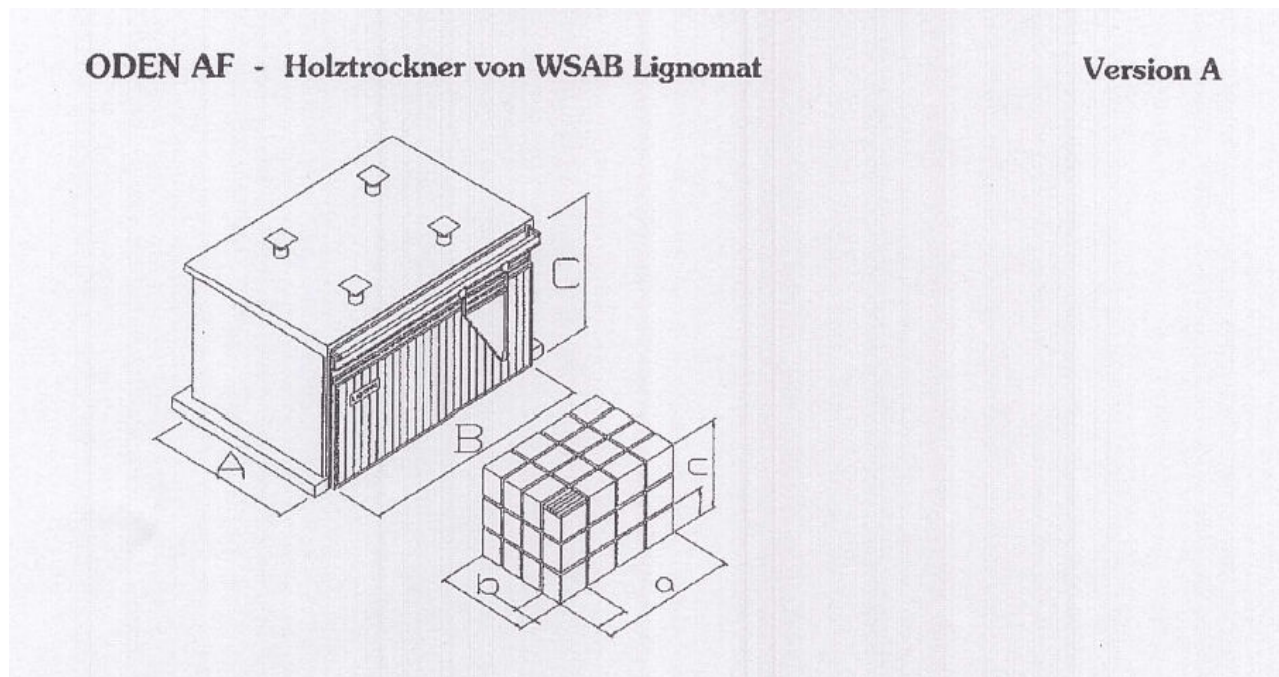

Chamber Internal Dimensions:

- Length/Depth	8,200 mm
- Width	13,000 mm
- Height	5,800 mm

Dryer Door:

- Width	13,000 mm
- Height	4,200 mm
- Quantity	1

Stickers (spacers):

- Length	4 x 3,000 mm (or e.g. 3 x 4,000 mm)
- Width	4 x 1,150 mm
- Height	3 x 1,150 mm
- Number of Stickers:	48 pieces

Useful Content:

85 m³ at 25 mm wood thickness

WSAB LIGNOMAT

WSAB Lignomat GmbH

Version A

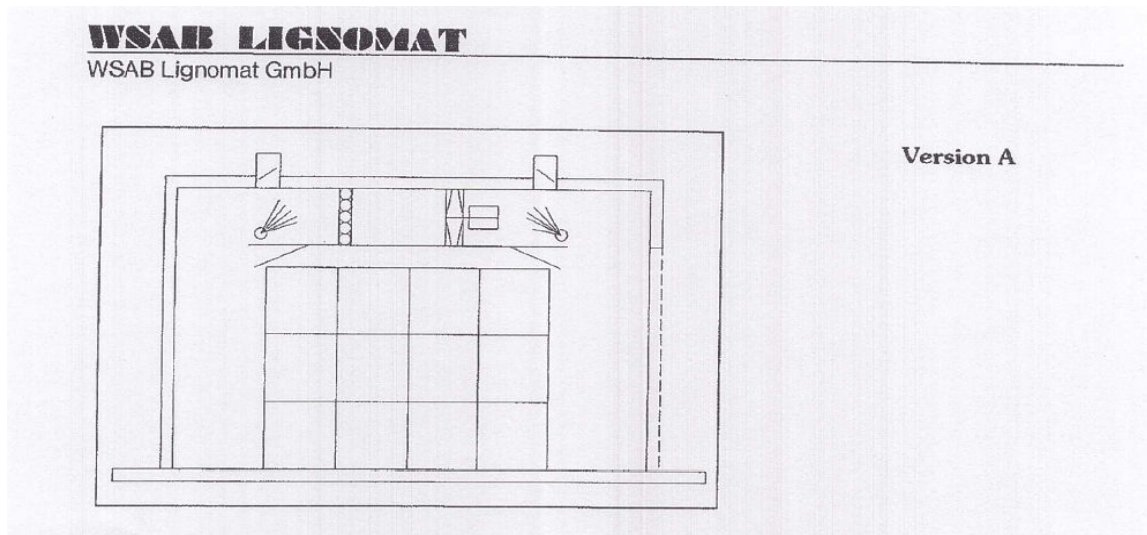

Design Basis:

- Wood type:	Spruce
- Raw density at 0% MC:	420 kg/m ³
- Wood thickness:	25 mm
- Sticker height:	25 mm
- Initial moisture:	maximal 90 %
- Final moisture:	13 %

Dryer Equipment:

- Control computer:	1 RIGI DR 4
- Temperature sensor:	2 pieces (drying temperature)
- Climate sensor:	1 piece (wet bulb temperature)
- WMC receiver for wood moisture:	2 pieces
- WMC transmitter for wood moisture measurement:	8 pieces
- Number of fans:	10 pieces with 7.5 kW per motor
- Air performance:	400,000 m ³ /h, reversible
- Air velocity:	3.8 m/s at 25 mm wood thickness
- Installed heating capacity:	850 kW = 731,000 kcal/h
- Drying temperature max.:	75 °C
- Heating medium:	95/80 °C warm water
- Fresh air intake flaps:	4 pieces
- Spray medium:	20 bar warm water, 80°C
- Spray systems:	2 pieces per dryer

Performance (per dryer):

Initial moisture 60 to 90% and usage time of	9,600 m ³ /year at 25 mm 340 days/year
--	--

WSAB LIGNOMAT

WSAB Lignomat GmbH

OVEN AF - Wood Dryer from WSAB Lignomat

Version B

Chamber Internal Dimensions:

- Length/Depth	8,200 mm
- Width	13,000 mm
- Height	5,800 mm

Dryer Door:

- Width	13,000 mm
- Height	4,200 mm
- Quantity	1

Stickers (spacers):

- Length	4 x 3,000 mm (or e.g. 3 x 4,000 mm)
- Width	4 x 1,150 mm
- Height	3 x 1,150 mm
- Number of Stickers:	48 pieces

Useful Content:

121 m³ at 60 mm wood thickness
141 m³ at 120 mm wood thickness

WSAB LIGNOMAT

WSAB Lignomat GmbH

Version B

Design Basis:

- Wood type:	Spruce
- Raw density at 0% MC:	420 kg/m ³
- Wood thickness:	60 mm and 120 mm
- Sticker height:	25 mm
- Initial moisture:	maximal 60 %
- Final moisture	17 %

Dryer Equipment:

- Control computer:	1 RIGI DR 4
- Temperature sensor	2 pieces (drying temperature)
- Climate sensor:	1 piece (wet bulb temperature)
- WMC receiver for wood moisture:	2 pieces
- WMC transmitter for wood moisture measurement	8 pieces
- Number of fans:	7 pieces with 7.5 kW per motor
- Air performance:	280,000 m ³ /h, reversible
- Air velocity:	4.0 m/s at 60 mm wood thickness
- Installed heating capacity:	600 kW = 387,000 kcal/h
- Drying temperature max.:	75 °C
- Heating medium:	95/80 °C warm water
- Fresh air intake flaps:	4 pieces
- Spray medium:	20 bar warm water, 80°C
- Spray systems	2 pieces per dryer

Performance (per dryer):

Initial moisture 60% and usage time of	6,900 m ³ at 60 mm and 3,800 m ³ /year at 120 mm 340 days/year
--	--