

Instructions for Setting up Installation

-Marked dimensions (e.g. Ø20) define the position of the single components of the installation relative to each other.

-In the case of a top program generated by the marked dimensions have to be observed for the course positions of the system components. The exact position of the components is determined in this case via the supplied program. (E.g. top view with the respective reference to check side by side the reference points marked on blue circles in the program and adjust the components accordingly)

Prepared for assembly:

Hit II anchor bolts M12x200, 10L, 9 pcs.

The customer has to verify that the foundation and the anchor bolts are installed in the correct position. The customer has to provide the foundation and the fastening elements accordingly.

-The anchor bolts are placed after the final adjustment of the installation. All dimensions which are not marked are historical dimensions and must not be taken into consideration for the adjustment.

-The cable channels should not have electrical connection between machine parts.

-Requirements on site

- - dry, purified compressed air, 6 bar
- - supply of 0.5/1.5/3 bar
- - position control cable
- - gas supply, 1 - 3 bar

Remarks re. foundations

-This drawing provides basic information for the adjustment of the foundation openings. The indicated data refer to the machine equipment only.

-The static calculations of the foundation will be done by the building contractor who is also responsible for the selection of the appropriate material and the necessary safety investigations.

-All cable channels should be made of an anti-magnetic material (e.g. Al-plate)

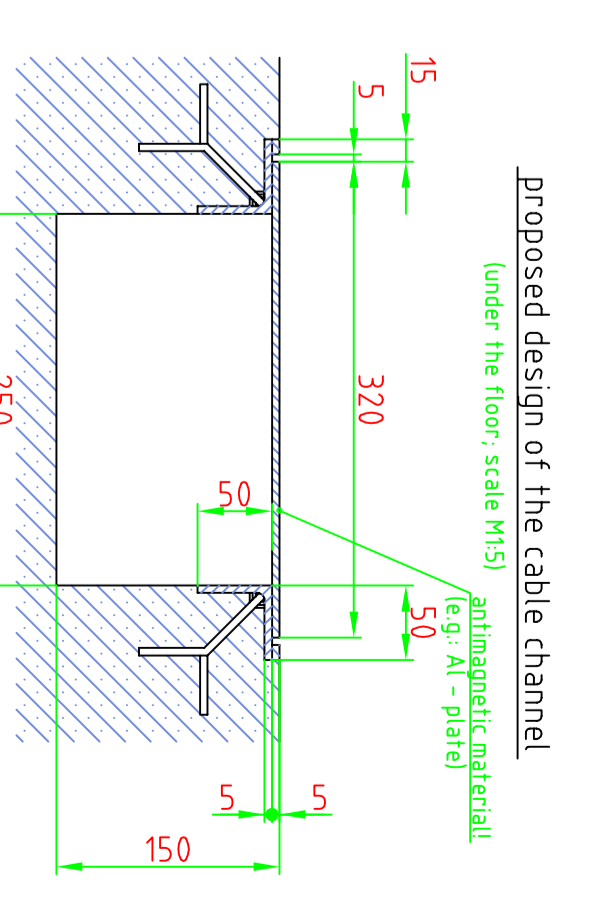

igmm (IGM Group) Ltd. 415

Address: 11485-10, Budapest, Hungary

Phone: +36 1 266 1100

Fax: +36 1 266 1101

Website: www.igmm.com

Project: RMB 11485-10

Contract No: 100611/301766/320187

Issue No: 2/2

Scale: 1:50

Author	28.05.2015	L. L. L.
Checked	03.07.2016	L. L. L.
Approved	03.07.2016	L. L. L.
Design		
Calculation		
Material		
Production		

LAYOUT

ForFace #2 "boom"

THISS: 10.04.16