

D	TECNISCHE DATEN	2
DINO	DV2802027	Manu-01

2.1.6.3 Leistungs- und Drehmomentkurve (TU* 18.000)

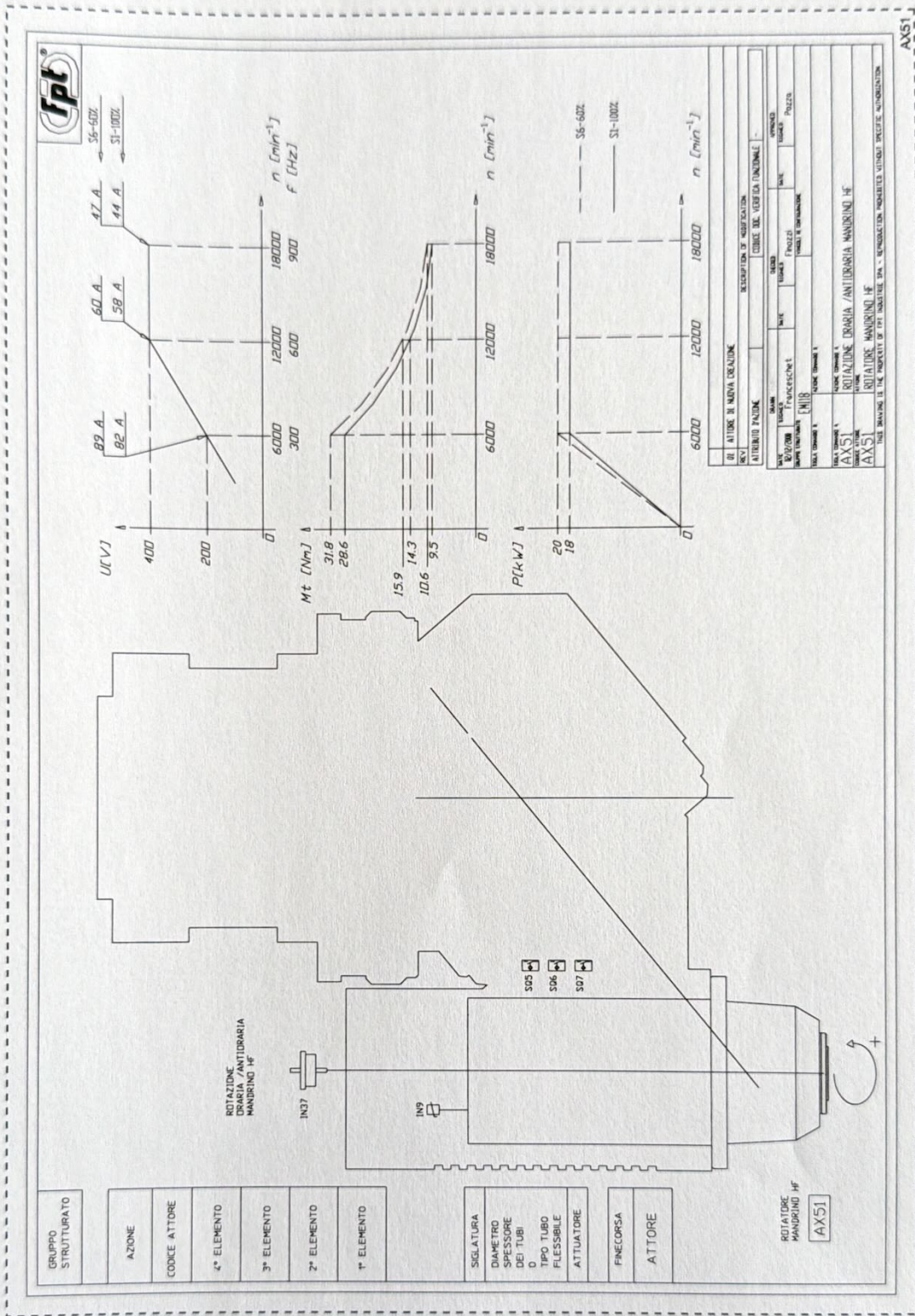

D			TECHNISCHE DATEN	2
DINO	DV28020R7			Manu-01

2.1.7 SPINDELNASE

2.1.7.1 Werkzeugaufnahmen

Die Spindel Nase ist für folgende Werkzeugaufnahmen vorgerüstet:

- HSK A 63 - DIN 69893
- HSK E 40 - DIN 69893

HSK
DIN 69893 Teil 1 Form A - E

HSK	L ₁ mm	D mm	D _{8 max.} mm	D ₁₀ mm	L ₃ mm	L ₄ mm
40	20	40	34	---	20	35
63	32	63	53	M18x1	26	42

DG-00108

D	TECHNISCHE DATEN		2
DINO	DV2802027		Manu-01

2.1.8 ÜBERSICHT DER TECHNISCHEN MASCHINENDATEN

DINO			
BESCHREIBUNG	ME	WERT	ANMERK.
Längshub (X)	mm	2800	
Vertikalhub (Z)	mm	800	
Querhub (Y)	mm	2200	
Arbeitsvorschübe	mm/min	35000	
Leistung Spindelmotor (Dauerbetrieb S1)	kW (PS)	Vgl. Drehmoment Diagramm	
Leistung Spindelmotor (Aussetzbetrieb S6 – 60%)	kW (PS)		
Drehzahlbereich der Spindel bei konstantem Drehmoment	1/min		
Drehzahlbereich der Spindel bei konstanter Leistung	1/min		
Höchstdrehmoment der Spindel (Aussetzbetrieb S6)	Nm		
Versorgungsspannung	Vac	400	(-15%, +10%) DIN VDE 0160
Frequenz	Hz	50	
Stromaufnahme	A	116	
INSTALLIERTE GESAMTLEISTUNG	kW (PS)	69 (93,84)	

TTD-T001

2.2 ABNAHMEZERTIFIKAT

Sämtliche von der Firma FPT Industrie S.p.A. gebauten Maschinen und Anlagen werden vor Auslieferung an den Kunden strengen geometrischen sowie funktionalen Abnahmeprüfungen unterzogen.

Die geometrische Abnahme der Portalfräsmaschinen erfolgt nach der Norm ISO 10791 ("Abnahmevorschriften für Bearbeitungszentren", Teil 2) und der Normreihe ISO 230 ("Abnahmeziffer der Werkzeugmaschinen"). Die Norm ISO 230/1 wird durch DIN 8601 umgesetzt.

Das beiliegende "Abnahmezertifikat" enthält die von FPT vor Übergabe der Maschine an den Kunden gemessenen geometrischen Werte. Diese Werte sind aufgrund der zahlreichen äußeren Störfaktoren der Messung (besonders hinsichtlich des bereitgestellten Fundaments) nicht bindend. Bei der Endabnahme der installierten Maschine gilt das gleiche Normprotokoll.

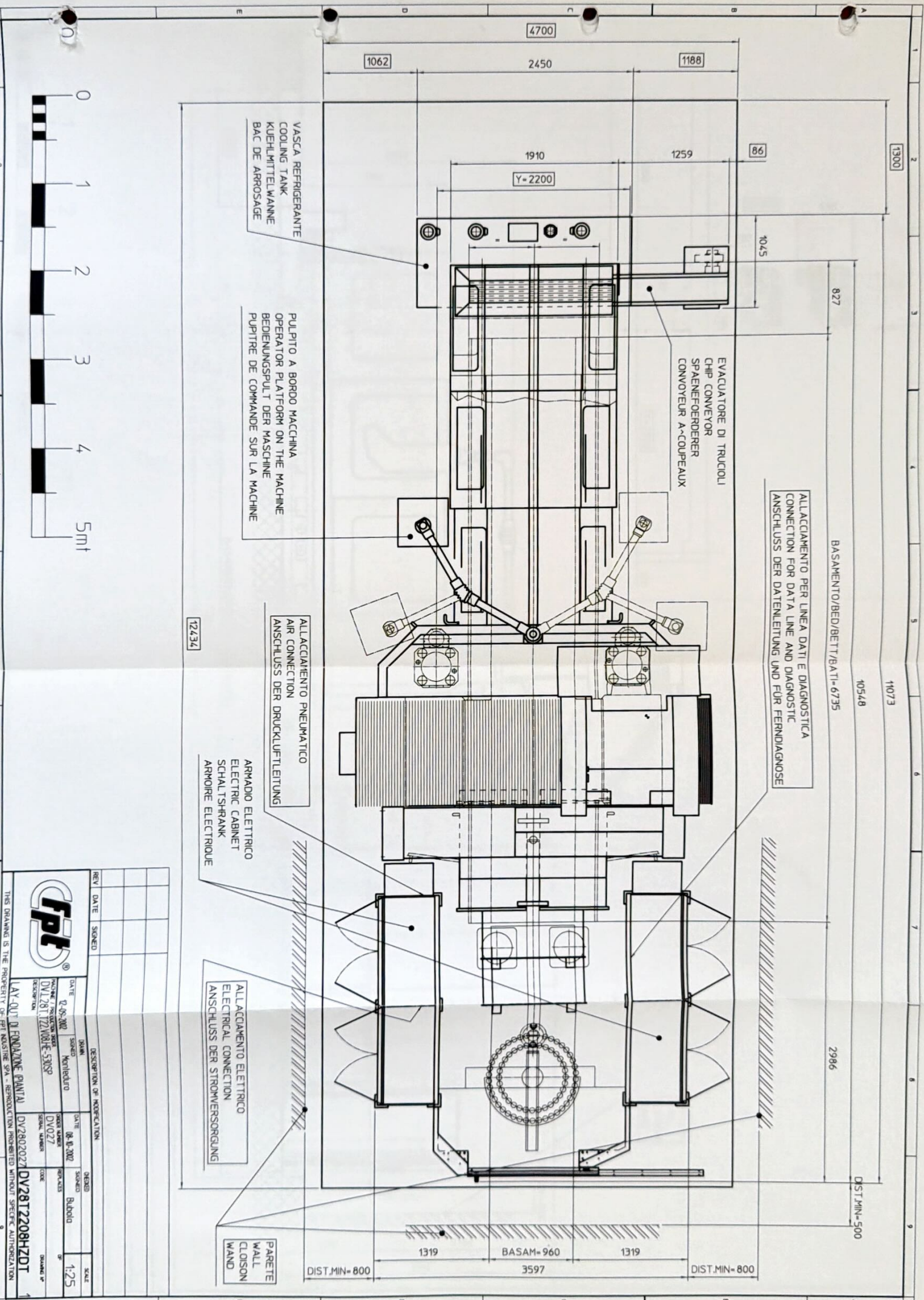

VASCA REFRIGERANTE
COOLING TANK
KUEHLMITTELWANNE
BAC DE ARROSAGE

PULPITO A BORDO MACCHINA
OPERATOR PLATFORM ON THE MACHINE
BEDIENUNGSPULT DER MASCHINE
PUITRE DE COMMANDE SUR LA MACHINE

EVALUATORE DI TRUCIOLI
CHIP CONVEYOR
SPAENEFOERDERER
CONVYEUR A-COPEAUX

ALLACCIAMENTO PER LINEA DATI E DIAGNOSTICA
CONNECTION FOR DATA LINE AND DIAGNOSTIC
ANSCHLUSS DER DATENLEITUNG UND FÜR FERNDIAGNOSE

ALLACCIAMENTO PNEUMATICO
AIR CONNECTION
ANSCHLUSS DER DRUCKLUFTLEITUNG

ARMADIO ELETTRICO
ELECTRIC CABINET
SCHALTSCHRANK
ARMOIRE ELECTRIQUE

ALLACCIAMENTO ELETTRICO
ELECTRICAL CONNECTION
ANSCHLUSS DER STROMVERSORGUNG

PARETE
WALL
CLONSON
WAND

BASAMENTO/BEDE/BET/BATI-6735

105,48

2986

DIST.MIN=500

DIST.MIN=800

BASAM-960

DIST.MIN=800

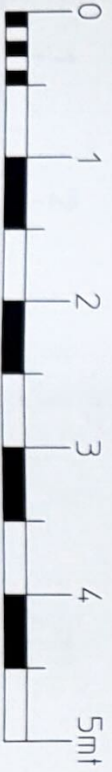

REV	DATE	SIGNED	DESCRIPTION OF MODIFICATION	SCALE
1	02-05-2002	Monteduro		1:25
2	08-10-2002	Bubola		

DATE	SIGNED	DATE	SIGNED
02-05-2002	Monteduro	08-10-2002	Bubola
DRAWING / PROJEKTION NAME	DW/0227	DRAWING / PROJEKTION NAME	DW/0227
DWL 281 T22 V08 IE-50SP		DWL 281 T22 V08 IE-50SP	
REVISION		REVISION	

LAVORO DI FONDAZIONE PAVATA DV2802027 DV2812208HZDI
 THIS DRAWING IS THE PROPERTY OF FPI INDUSTRIE SPA - REPRODUCTION PROHIBITED WITHOUT SPECIFIC AUTHORIZATION

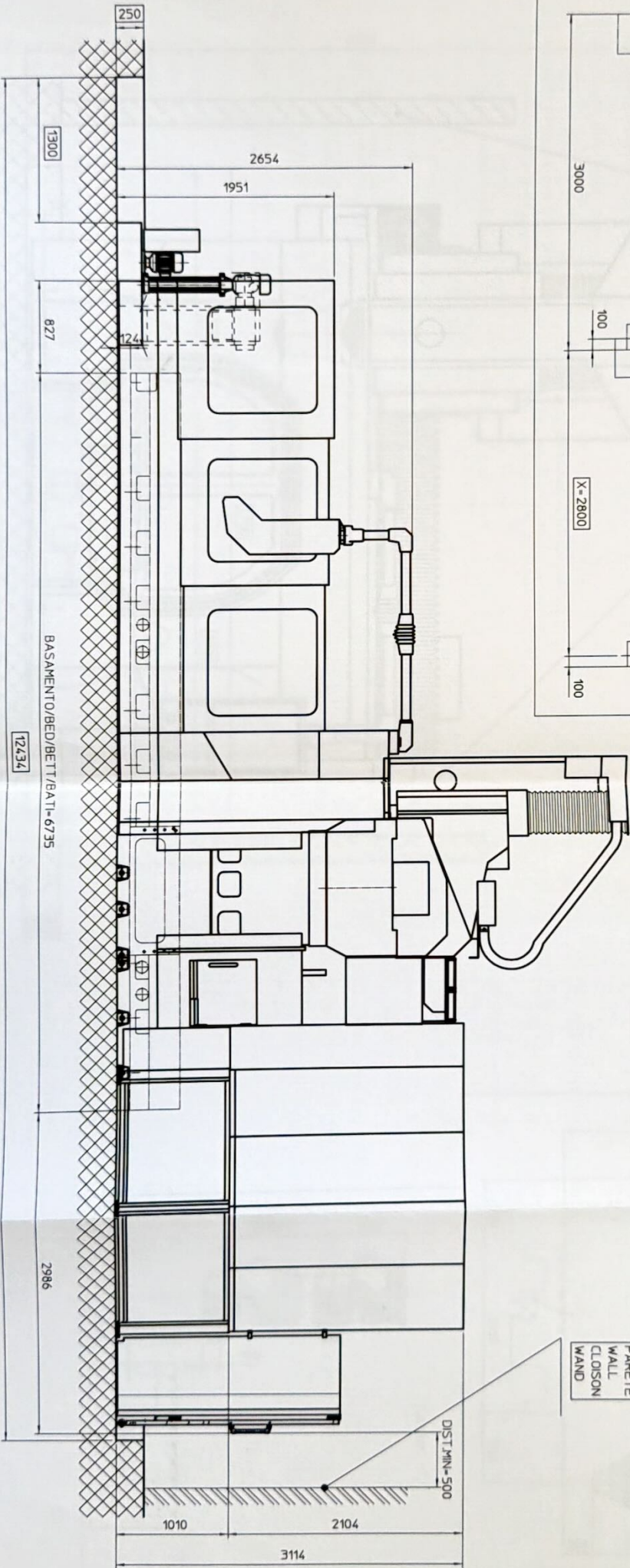
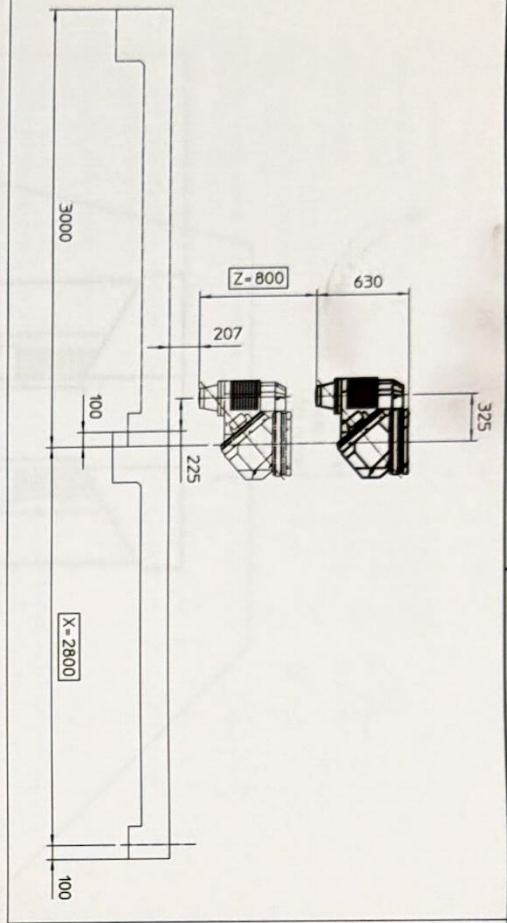

PARETE
WALL
CLOISON
WAND



REV	DATE	SIGNED	DESCRIPTION OF MODIFICATION

fpt

THIS DRAWING IS THE PROPERTY OF fpt INDUSTRIE SPA - REPRODUCTION PROHIBITED WITHOUT SPECIFIC AUTHORIZATION

DATE	SIGNED	DESCRIPTION	DATE	SIGNED	DESCRIPTION
2-09-2002	Monteduro		28.11.2002	Bubola	
NAME / PROJECT CODE DV1281172108/E-530SP			DRAWING N° DV2802027/DV2812208H/ZDT		
SCALE 1:25			DRAWING N° 2		

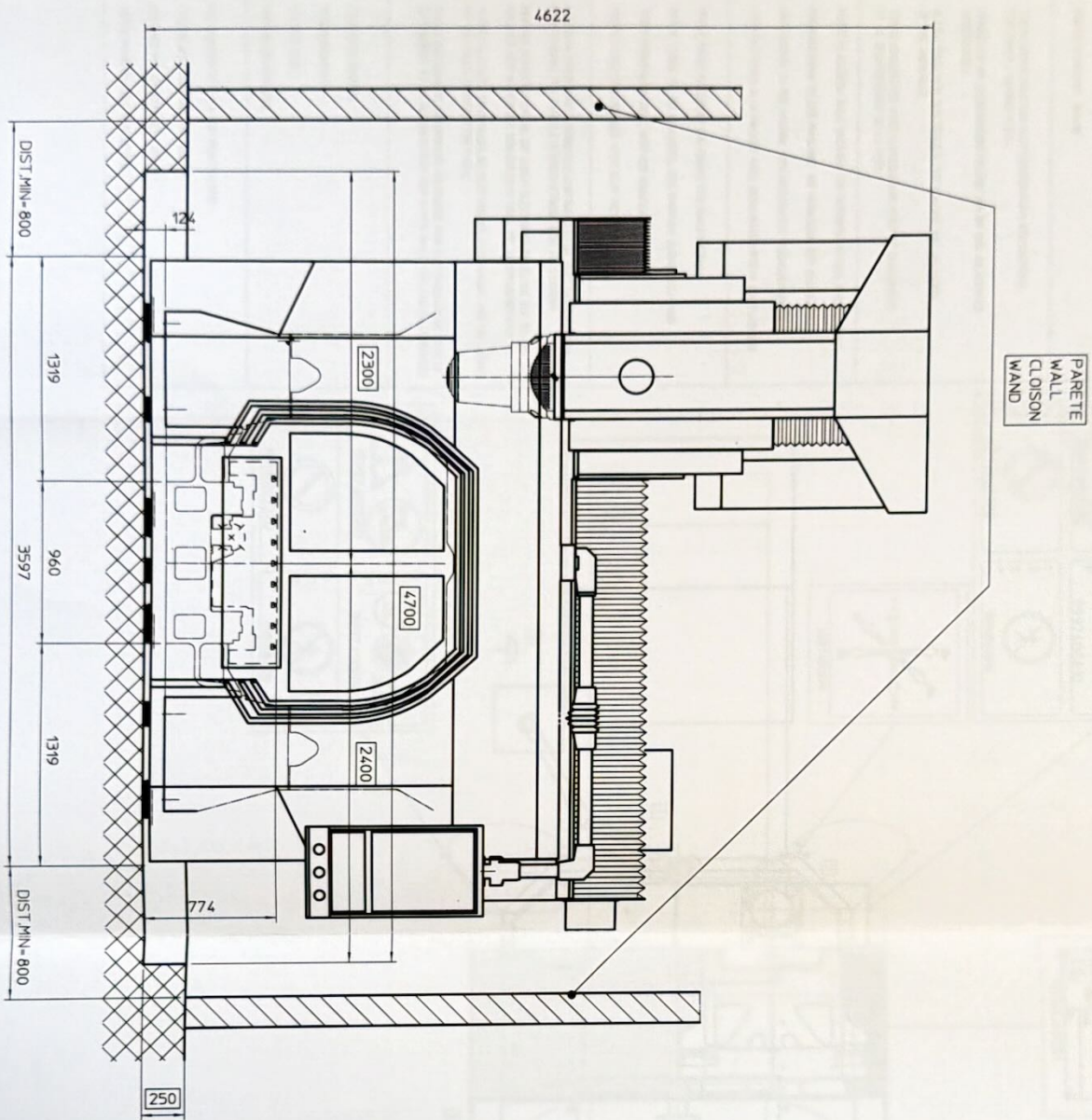

PARETE
WALL
CLOISON
WAND

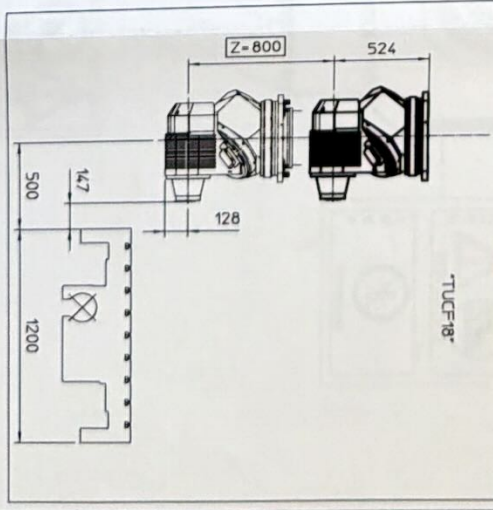
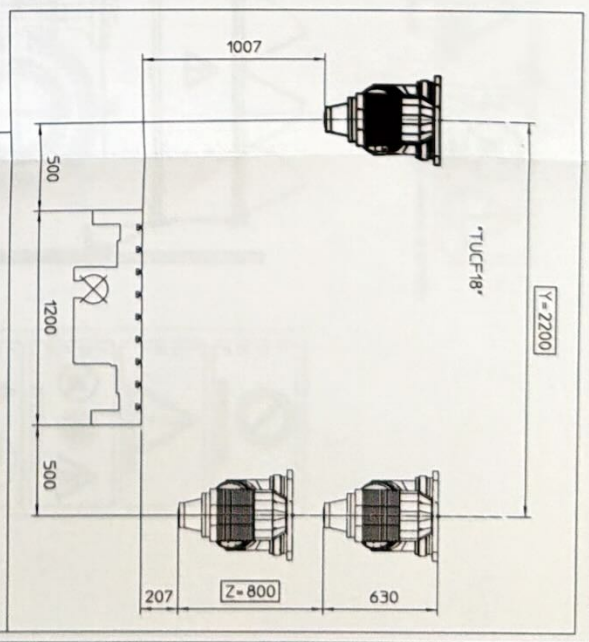

REV	DATE	SIGNED	DESCRIPTION OF MODIFICATION

	LAB-OUT MATERIAL <small>THIS DRAWING IS THE PROPERTY OF FPT INDUSTRIE SPA - REPRODUCTION PROHIBITED WITHOUT SPECIFIC AUTHORIZATION</small>
DATE 2-09-2002 <small>PROJ. / INGEN. / DES. / EXEC.</small> DV/281722/08/E-303P	SCALE 1:20
SCALE 1:20	DATE 08-09-2002 <small>PROJ. / INGEN. / DES. / EXEC.</small> DV/022
SCALE 1:20	DATE 08-09-2002 <small>PROJ. / INGEN. / DES. / EXEC.</small> DV/280202Z/DV28172208H/DI
SCALE 1:20	DATE 08-09-2002 <small>PROJ. / INGEN. / DES. / EXEC.</small> DV/281722/08/E-303P
SCALE 1:20	DATE 08-09-2002 <small>PROJ. / INGEN. / DES. / EXEC.</small> DV/281722/08/E-303P

PULSANTI D'EMERGENZA EMERGENCY STOP / EMERGENCY STOP / EMERGENCY STOP

PORTA SCORREVOLE CON ELETTROSERRATURA PER CARICO / SCARICO PEZZI

SCHEMATA MIT ELEKTROVERBREMUNG ZUM BE- UND ABLAGENDES WERKSTÜCKES

PORTE DI ACCESSO ALLA MACCHINA CON INTERRUPTORE ENERGETICO ENKANGSSTREBEN ZU DER MASCHINE MIT WERKSCHALTER ENERGENZ

PORTE FISSE ACCESSIBILI CON CHIAVE PER MANUTENZIONE FESTE TÜREN DIE MIT SCHLÜSSEL ZUR WARTUNG ZUGANGSLOS SIND PORTES FIXES ACCESSIBLES AVEC CLÉF POUR ENTRETIEN

CANDELLA POSTERIORE SCORREVOLE CONTROLLATO DA ELETTROSERRATURA ENERGENZHEBEN PER CARICO / SCARICO UTENSILI CON PULSANTEA

PULSANTO DI COMANDO BEWENKUNGSPULT CONTROL UNIT PAFRINE DE COMMANDE

ALLOGGIAMENTO SCALA PER MANUTENZIONE LAGERPLATZ FÜR WARTUNGSELETTEN STORAGE FOR MAINTENANCE LADDER DÉPÔT POUR ÉCHELLE PERMETTEN

9997400580

9997400610

9990062270

9997400570

9997400580

9997400610

9990062270

9997400590

9997400600

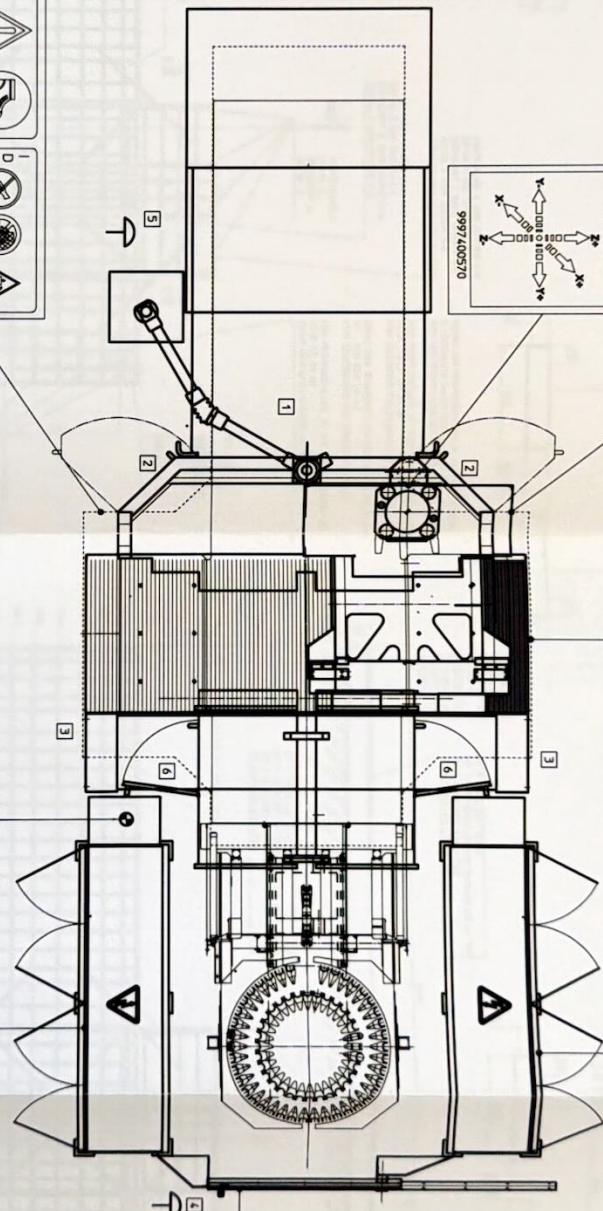
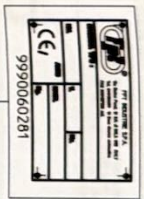

SU PANNELLO ARMADIO INFERIORE

SU PORTA ARMADIO ELETTRICO

9997400590

9997400600

PUNTO DI INGRESSO POTENZA ELETTRICA E ARIA

ENKANGSPUNKT DER ELEKTRISCHEN VERSORGUNG UND LUFT

ENTRY POINT OF ELECTRICAL POWER AND AIR

POINT D'ACCES PUISSANCE ELECTRIQUE ET AIR

SU PANNELLO ARMADIO INFERIORE

SU PORTA ARMADIO ELETTRICO

9997400590

9997400600

9990062270

9997400580

9997400610

9997400590

9997400600

		DESCRIZIONE DI NEGOZIAZIONE TRADE DESCRIPTION	
MODELLO DVO077	IDENTIFICAZIONE IDENTIFICATION	DIMENSIONI DIMENSIONS	QUANTITÀ QUANTITY
DATA DATE	LUOGO PLACE	STATO COUNTRY	VALORE VALUE
12/20	12/20	12/20	12/20

SECTION A-A PARTICOLARE F.P.M. STIFFE CORRE AND
SECTION A-A DETAIL F.P.M. STIFFE CORRE AND
SECTION A-A DETAIL F.P.M. STIFFE CORRE AND
SECTION A-A DETAIL F.P.M. STIFFE CORRE AND

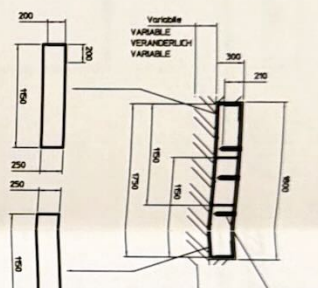

FOR THE SECTIONS CARATTERI AND
HOLEY OF THE FOLLOWING CORRE CORRE AND
UNDER THE CORRE CORRE CORRE AND
UNDER THE CORRE CORRE CORRE AND

CALESTRAZIONE MURO E SOTTOPAVIMENTO
MATERIE PER L'INTERVALLO
MURO MURO DIVERSE IN SOTTO-CORRE

SECTION C-C PARTICOLARE F.P.M. STIFFE CORRE AND
SECTION C-C DETAIL F.P.M. STIFFE CORRE AND
SECTION C-C DETAIL F.P.M. STIFFE CORRE AND
SECTION C-C DETAIL F.P.M. STIFFE CORRE AND

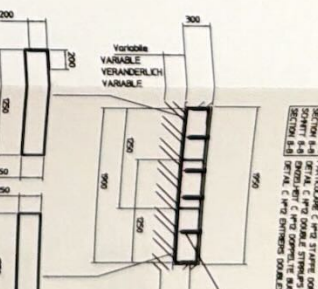

FOR THE SECTIONS CARATTERI AND
HOLEY OF THE FOLLOWING CORRE CORRE AND
UNDER THE CORRE CORRE CORRE AND
UNDER THE CORRE CORRE CORRE AND

CALESTRAZIONE MURO E SOTTOPAVIMENTO
MATERIE PER L'INTERVALLO
MURO MURO DIVERSE IN SOTTO-CORRE

STIFFE CORRE AND
CORRE CORRE AND
CORRE CORRE AND
CORRE CORRE AND

PARTICOLARE A - P.M. STIFFE CORRE AND
SECTION A-A DETAIL F.P.M. STIFFE CORRE AND
SECTION A-A DETAIL F.P.M. STIFFE CORRE AND
SECTION A-A DETAIL F.P.M. STIFFE CORRE AND

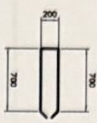

PARTICOLARE E - P.M. STIFFE CORRE AND
SECTION E-E DETAIL F.P.M. STIFFE CORRE AND
SECTION E-E DETAIL F.P.M. STIFFE CORRE AND
SECTION E-E DETAIL F.P.M. STIFFE CORRE AND

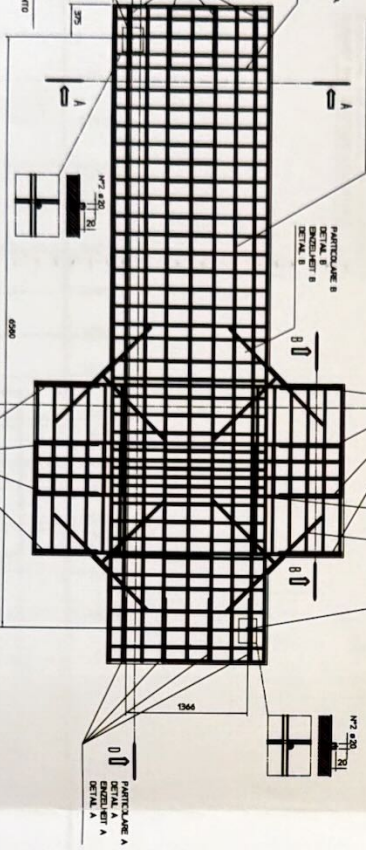

PER IL SOTTOPAVIMENTO AL SOTTO-CORRE
E SOTTOPAVIMENTO AL SOTTO-CORRE
E SOTTOPAVIMENTO AL SOTTO-CORRE
E SOTTOPAVIMENTO AL SOTTO-CORRE

PARTICOLARE D - P.M. STIFFE CORRE AND
SECTION D-D DETAIL F.P.M. STIFFE CORRE AND
SECTION D-D DETAIL F.P.M. STIFFE CORRE AND
SECTION D-D DETAIL F.P.M. STIFFE CORRE AND

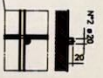

PARTICOLARE C - P.M. STIFFE CORRE AND
SECTION C-C DETAIL F.P.M. STIFFE CORRE AND
SECTION C-C DETAIL F.P.M. STIFFE CORRE AND
SECTION C-C DETAIL F.P.M. STIFFE CORRE AND



PARTICOLARE B - P.M. STIFFE CORRE AND
SECTION B-B DETAIL F.P.M. STIFFE CORRE AND
SECTION B-B DETAIL F.P.M. STIFFE CORRE AND
SECTION B-B DETAIL F.P.M. STIFFE CORRE AND

PARTICOLARE A - P.M. STIFFE CORRE AND
SECTION A-A DETAIL F.P.M. STIFFE CORRE AND
SECTION A-A DETAIL F.P.M. STIFFE CORRE AND
SECTION A-A DETAIL F.P.M. STIFFE CORRE AND

PARTICOLARE B - P.M. STIFFE CORRE AND
SECTION B-B DETAIL F.P.M. STIFFE CORRE AND
SECTION B-B DETAIL F.P.M. STIFFE CORRE AND
SECTION B-B DETAIL F.P.M. STIFFE CORRE AND

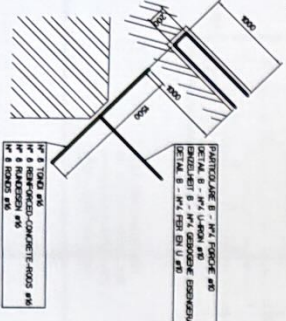

PARTICOLARE E - P.M. STIFFE CORRE AND
SECTION E-E DETAIL F.P.M. STIFFE CORRE AND
SECTION E-E DETAIL F.P.M. STIFFE CORRE AND
SECTION E-E DETAIL F.P.M. STIFFE CORRE AND

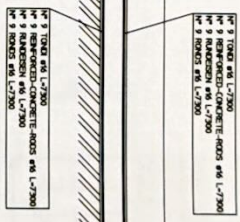

PARTICOLARE F - P.M. STIFFE CORRE AND
SECTION F-F DETAIL F.P.M. STIFFE CORRE AND
SECTION F-F DETAIL F.P.M. STIFFE CORRE AND
SECTION F-F DETAIL F.P.M. STIFFE CORRE AND

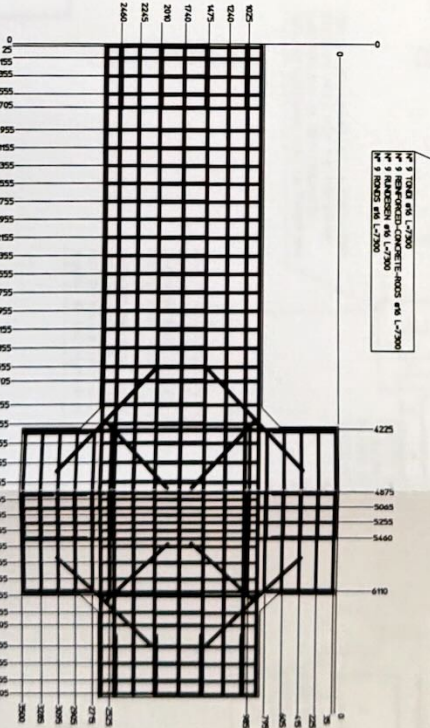

PARTICOLARE D - P.M. STIFFE CORRE AND
SECTION D-D DETAIL F.P.M. STIFFE CORRE AND
SECTION D-D DETAIL F.P.M. STIFFE CORRE AND
SECTION D-D DETAIL F.P.M. STIFFE CORRE AND

PARTICOLARE C - P.M. STIFFE CORRE AND
SECTION C-C DETAIL F.P.M. STIFFE CORRE AND
SECTION C-C DETAIL F.P.M. STIFFE CORRE AND
SECTION C-C DETAIL F.P.M. STIFFE CORRE AND

PARTICOLARE B - P.M. STIFFE CORRE AND
SECTION B-B DETAIL F.P.M. STIFFE CORRE AND
SECTION B-B DETAIL F.P.M. STIFFE CORRE AND
SECTION B-B DETAIL F.P.M. STIFFE CORRE AND

PARTICOLARE A - P.M. STIFFE CORRE AND
SECTION A-A DETAIL F.P.M. STIFFE CORRE AND
SECTION A-A DETAIL F.P.M. STIFFE CORRE AND
SECTION A-A DETAIL F.P.M. STIFFE CORRE AND

Scale: 1:200

Scale: 1:200

PROGETTO	REVISIONI	DATA
1		
2		
3		
4		
5		
6		
7		
8		
9		
10		
11		
12		
13		
14		
15		
16		
17		
18		
19		
20		
21		
22		
23		
24		
25		
26		
27		
28		
29		
30		
31		
32		
33		
34		
35		
36		
37		
38		
39		
40		
41		
42		
43		
44		
45		
46		
47		
48		
49		
50		
51		
52		
53		
54		
55		
56		
57		
58		
59		
60		
61		
62		
63		
64		
65		
66		
67		
68		
69		
70		
71		
72		
73		
74		
75		
76		
77		
78		
79		
80		
81		
82		
83		
84		
85		
86		
87		
88		
89		
90		
91		
92		
93		
94		
95		
96		
97		
98		
99		
100		

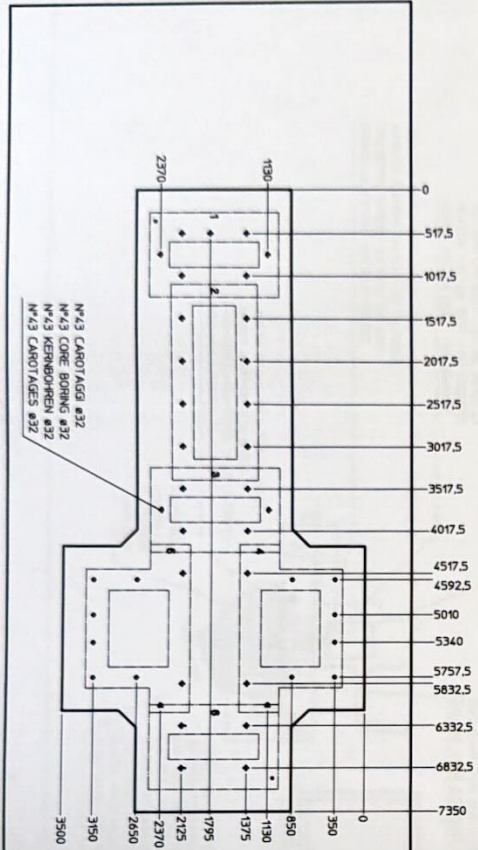

PERMETRO DI FONDAZIONE
TANK TO CONTAIN MORTAR
SCHÄUBLE ZUM ENTHALTEN VON MORTEL
GABARIT PUR CONTENIR LE MORTIER

PIANO PAVIMENTO
FLOOR LEVEL
FLOORBOARD STAND
NIVEL DU SOL

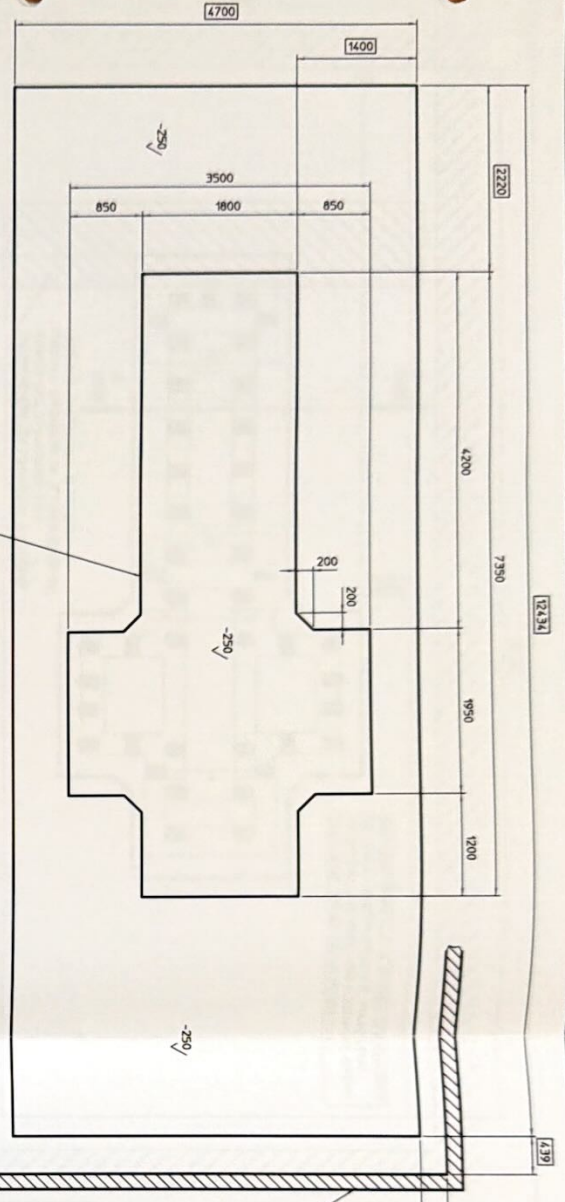

PARETE WALL CLOSURE MAND

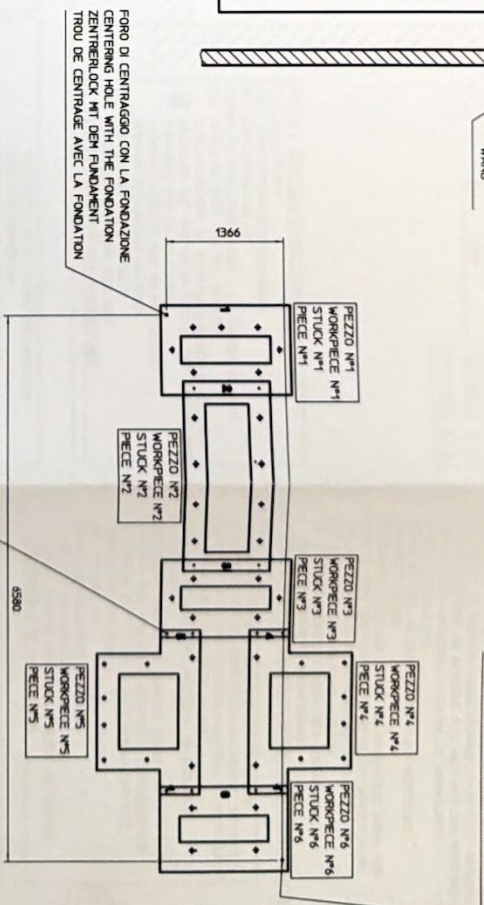

FORO DI CENTRAGGIO CON LA FONDAZIONE
CENTERING HOLE WITH THE FOUNDATION
ZENTRIERLOCK MIT DEM FUNDAMENT
TROU DE CENTRAGE AVEC LA FONDAATION

FORO DI CENTRAGGIO CON LA FONDAZIONE
CENTERING HOLE WITH THE FOUNDATION
ZENTRIERLOCK MIT DEM FUNDAMENT
TROU DE CENTRAGE AVEC LA FONDAATION

- VITE T8I M8X12 L41 5739 (N°12)
- SCHRAE M8X12 L41 5739 (N°12)
- SCHRAE M8X12 L41 5739 (N°12)
- VIS M8X12 L41 5739 (N°12)
- DADO M8 L41 5587 (N°12)
- MUTTER M8 L41 5587 (N°12)
- ECCROU M8 L41 5587 (N°12)

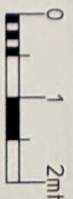

NOTE: PRESSIONE DEI FORI SU FONDAZIONE: 115 mm DA ESIGERE CON MASCHERA DI FORATURA FONDATA DA FPT
NOTE: PRESSIONE OF THE HOLES ON THE FOUNDATION: 115mm TO EXECUTE WITH A FPT TOOLMAKER'S BUTTIN
BEMERKUNG: GEWÄHRLEISTUNG DER LÖCHER AUF FUNDAMENT: 115mm SIE MIT DER VON FPT GELIEFERTEN BOHRVORRICHTUNG AUSZUFÜHREN
NOTE: PRESSION DES TROUS SUR FONDAATION: 115mm A EXECUTER AVEC GABARIT DE PERÇAGE LIVRE DE FPT

		DESCRIZIONE DI REALIZZAZIONE REALIZZAZIONE		DATA 12/2017	
NOME ...	COGNOME ...	NOME ...	COGNOME ...	DATA ...	DATA ...
NOME ...		COGNOME ...		DATA ...	
NOME ...		COGNOME ...		DATA ...	

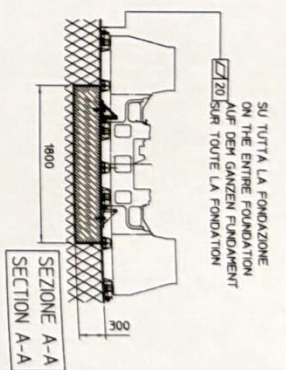
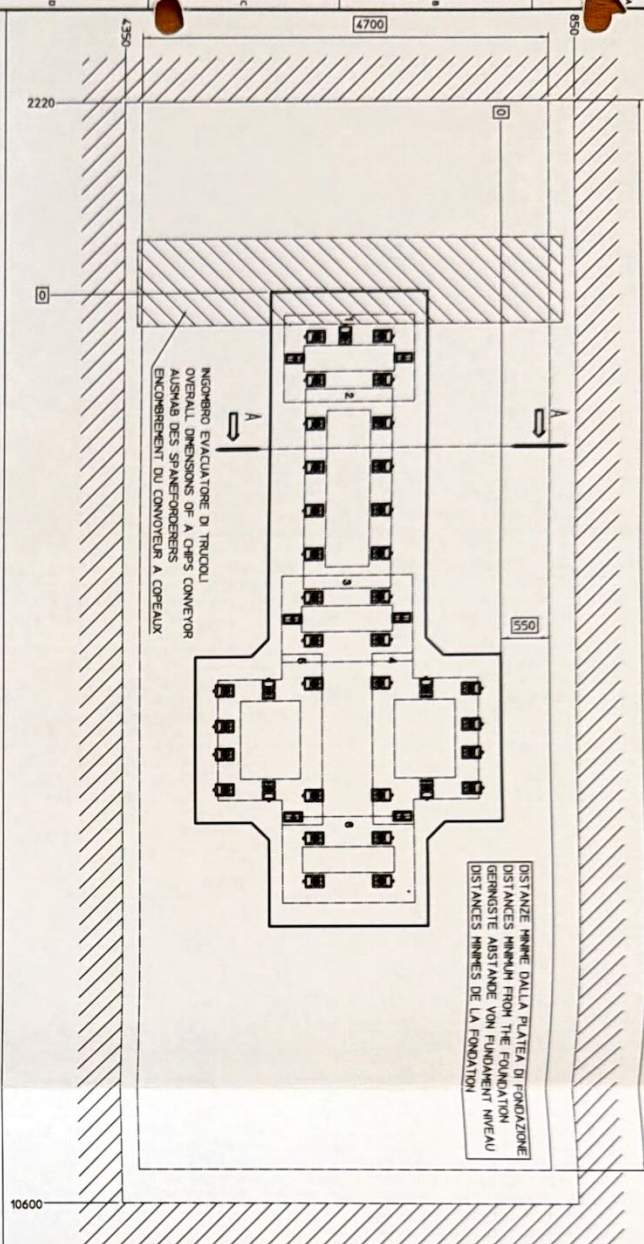

TUTTO IL MATERIALE DI LIVELLAMENTO
E' A CARICO DI PFT
ALLE VERANKERUNGSVORRICHTUNGEN
SIND ZUM LASTEN VON PFT
-VENS DE NIVELEMENT SONT A LA CHARGE DE PFT
-ALL LEVELLING UNITS ARE PFT-SCHARGE
L'LEVELLING UNIT BWF RK IF P-FIP-MES BANKALE MACCHINA
LEVELING UNIT BWF RK IF P-FIP-MES FOR MACHINE BED
ANSTRICHTELEMENTE BWF RK IF P-FIP-MES
SPRINTOR SU BANKALE MACCHINA
WINKEL FLIER MASCHINENBETT
FOUSSEURS POUR BANK MONTANT
LATERAL GOVERNOR FOR MACHINES BED

1) SE LA MACCHINA VENE INSTALLATA SU UNA FONDAZIONE ESISTENTE
DEVONO ESSERE RISPETTATE LE SEGUENTI CONDIZIONI:
-LOCALLIZZAZIONE DELLA MACCHINA LONTANA DA MACCHINARI O IMPIANTI
-L'IMPIANTO DEVE ESSERE ANCORATO AD UN UNICO BLOCCO DI FONDAZIONE
-PROFONDITA' MINIMA DELLA SOLETTA SIA ALMENO 300 mm
DELLA SOLETTA, DEVE ESSERE IN OGNI CASO REALIZZATA LA SEGUENTE
CONDIZIONE: E=1/20 X (1+1/2 Kg/m² DOVE:
-E= MODULO DI ELASTICITA' EQUIVALENTE DELLA FONDAZIONE
(EQUIVO PU' ARMATA)
-1/2= MONTANTE DI MEZZA PER OGNI METRO DI SEZIONE TRASVERSALE
DELLA FONDAZIONE.

1) SE LA MACCHINA VENE INSTALLATE SUR UNE FONDAZIONE EXISTENTE
DEVONT ETRE RESPECTEES LES SEQUENTES CONDITIONS:
-LOCALISATION DE LA MACHINE LOINTAIN DE MACHINERIE OU IMPLANTS
-L'INSTALLATION DOIT ETRE ANCRÉE A UN SEUL BLOC
DE FONDATION.
-PROFONDEUR MINIME DE LA SOLETTA 300mm
-SI LE MONT PAS POSSIBLE DE RESPECTER L'ESPACEMENT DE
LA SOLETTA EN TOUT CAS IL FAUT QUE LA SIVANTE
CONDITION SOIT REALISEE:
E=1/20 X (1+1/2 Q)
E= MODULE D'ELASTICITE FONDATION
(EQUIVO PLUS ARMATURE)
-1/2= MONTANT DE MEZIE POUR CHAQUE METRE DE SECTION
TRANSVERSALE DE LA FONDATION.

BARRA FILETTATA H20X30X (COD. PFT 1266000010)
THREADED BAR H20X30 (COD. PFT 1266000010)
GESCHNITTENE STANGE H20X30 (COD. PFT 1266000010)
BARRÈ FILETÈ H20X30 (COD. PFT 1266000010)

DADO H 20 UN 5587 - 86 BRUNTO (COD. PFT 510153060)
NUT H20 UN 5587 - 86 DL. BLACKED
MUTTER H20 UN 5587 - 86 BRONNERI
EGROU H20 UN 5587 - 86 BRON

SAGOMA DI CONTENIMENTO DELLA MALTA
TAKK TO CONTAIN MORTAR
SCHÄBLONE ZUM ENTHALTEN VON MORTEL
GABARIT POUR CONTENIR LE MORTIER

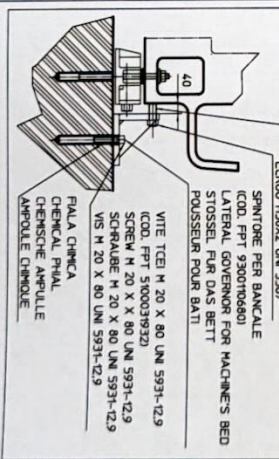
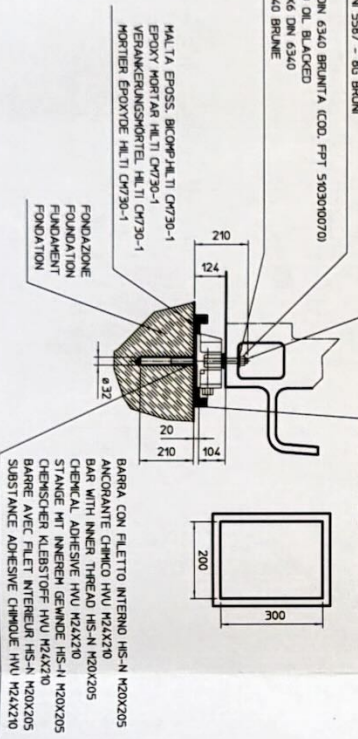

VITE STEI H 30 X 2 X 100 UNI 5923-129
(COD. PFT 510007236)
SCREW H30 X 2 X 100 UNI 5923-129
SCHRAUBE H30 X 2 X 100 UNI 5923-129
VIS H30 X 2 X 100 UNI 5923-129

DADO H30X2 UNI 5587
(COD. PFT 510153200)
NUT H30X2 UNI 5587
MUTTER H30X2 UNI 5587
EGROU H30X2 UNI 5587

SPRINTOR PER BANKALE
(COD. PFT 930010680)
LATERAL GOVERNOR FOR MACHINES BED
STOSSEL FÜR DAS BETT
FOUSSEUR POUR BATTI

VITE TCEI H 20 X 80 UNI 5931-129
(COD. PFT 510003932)
SCREW H 20 X 80 UNI 5931-129
SCHRAUBE H 20 X 80 UNI 5931-129
VIS H 20 X 80 UNI 5931-129

1) SE LA MACCHINA VENE INSTALLATA SU UNA FONDAZIONE ESISTENTE
DEVONO ESSERE RISPETTATE LE SEGUENTI CONDIZIONI:
-LOCALLIZZAZIONE DELLA MACCHINA LONTANA DA MACCHINARI O IMPIANTI
-L'IMPIANTO DEVE ESSERE ANCORATO AD UN UNICO BLOCCO DI FONDAZIONE
-PROFONDITA' MINIMA DELLA SOLETTA SIA ALMENO 300 mm
DELLA SOLETTA, DEVE ESSERE IN OGNI CASO REALIZZATA LA SEGUENTE
CONDIZIONE: E=1/20 X (1+1/2 Kg/m² DOVE:
-E= MODULO DI ELASTICITA' EQUIVALENTE DELLA FONDAZIONE
(EQUIVO PU' ARMATA)
-1/2= MONTANTE DI MEZZA PER OGNI METRO DI SEZIONE TRASVERSALE
DELLA FONDAZIONE.

1) SE LA MACCHINA VENE INSTALLATE SUR UNE FONDAZIONE EXISTENTE
DEVONT ETRE RESPECTEES LES SEQUENTES CONDITIONS:
-LOCALISATION DE LA MACHINE LOINTAIN DE MACHINERIE OU IMPLANTS
-L'INSTALLATION DOIT ETRE ANCRÉE A UN SEUL BLOC
DE FONDATION.
-PROFONDEUR MINIME DE LA SOLETTA 300mm
-SI LE MONT PAS POSSIBLE DE RESPECTER L'ESPACEMENT DE
LA SOLETTA EN TOUT CAS IL FAUT QUE LA SIVANTE
CONDITION SOIT REALISEE:
E=1/20 X (1+1/2 Q)
E= MODULE D'ELASTICITE FONDATION
(EQUIVO PLUS ARMATURE)
-1/2= MONTANT DE MEZIE POUR CHAQUE METRE DE SECTION
TRANSVERSALE DE LA FONDATION.

REQUISITI PER LA REALIZZAZIONE DELLA FONDAZIONE:
- PORTATA DEL TERRENO MIN. 10 Kg/cmq -

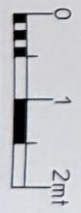

NO	DATE	STATO	DESCRIZIONE DI MODIFICAZIONE	REDAZIONE	SCALE
1	15/08/2002	PROGETTO	PROGETTO	Baldoni	1:30
2	15/08/2002	PROGETTO	PROGETTO	Baldoni	1:30
3	15/08/2002	PROGETTO	PROGETTO	Baldoni	1:30
4	15/08/2002	PROGETTO	PROGETTO	Baldoni	1:30
5	15/08/2002	PROGETTO	PROGETTO	Baldoni	1:30
6	15/08/2002	PROGETTO	PROGETTO	Baldoni	1:30
7	15/08/2002	PROGETTO	PROGETTO	Baldoni	1:30