



NORTH AMERICA

UNITED STATES

ONE MICHAEL OWENS WAY
PERRYSBURG, OHIO 43061

PRODUCT DEVELOPMENT

THIS BOTTLE, AS DESIGNED, DOES NOT PROVIDE STANDARD CROWN REST PLATFORM CLEARANCE. CUSTOMER MUST CONTACT THE EQUIPMENT SUPPLIER TO CONFIRM THAT SUITABLE CLEARANCE IS AVAILABLE.

① FILL POINT(S) - APPROXIMATE FILL LOCATION MAY VARY UP OR DOWN FROM THAT INDICATED.

C.I.D. DOT CODE AND CAVITY NUMBER TO APPEAR ON HEEL. CAVITY NUMBER TO BE 3.18 [1.125] TALL.

HEEL LETTERING TO APPEAR ON SIDE OPPOSITE C.I.D. DOT CODE, AND TO BE 3.18 [1.125] TALL.

OPTIONAL:
BOTTOM PLATE LETTERING TO BE 4.76 [1.188] TALL, WITH BAR BELOW LETTERING.

OPTIONAL:
C.I.D. RINGS OR DOT CODE TO APPEAR ON BOTTOM.

CRESCENT KNURLING TO APPEAR ON BEARING SURFACE.

CAUTION: C.I.D. DOT CODE PROTRUDES BEYOND THE MAJOR DIAMETER AND CONTACT POINT OF THIS CONTAINER. THIS MAY RESULT IN HANDLING PROBLEMS DURING PROCESSING.

THIS CONTAINER IS DESIGNED FOR PRODUCTS UP TO AND INCLUDING 4 GAS VOLUMES WITH NO PASTEURIZATION.

THIS CONTAINER IS DESIGNED FOR PASTEURIZED PRODUCTS UP TO AND INCLUDING 3.5 GAS VOLUMES WHERE PASTEURIZATION TEMPERATURE OF 145° F IS NOT EXCEEDED.

IT IS THE RESPONSIBILITY OF THE GLASS CONTAINER PURCHASER TO CONSULT WITH ITS CLOSURE AND CONTAINER SUPPLIERS TO DETERMINE THE APPROPRIATE PRESSURE LIMITS FOR THE COMBINATION OF THE CONTAINER, ITS FINISH, AND THE CLOSURE CHOSEN, WHEN THE CONTAINER WILL BE SUBJECTED TO PRESSURE OR USED FOR CONTENTS UNDER PRESSURE.

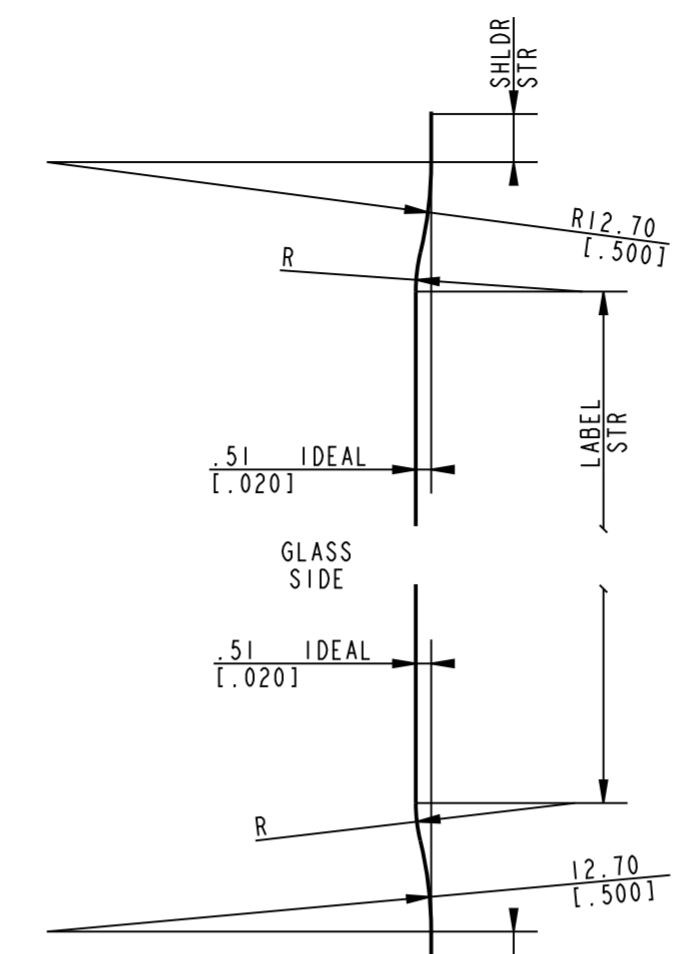
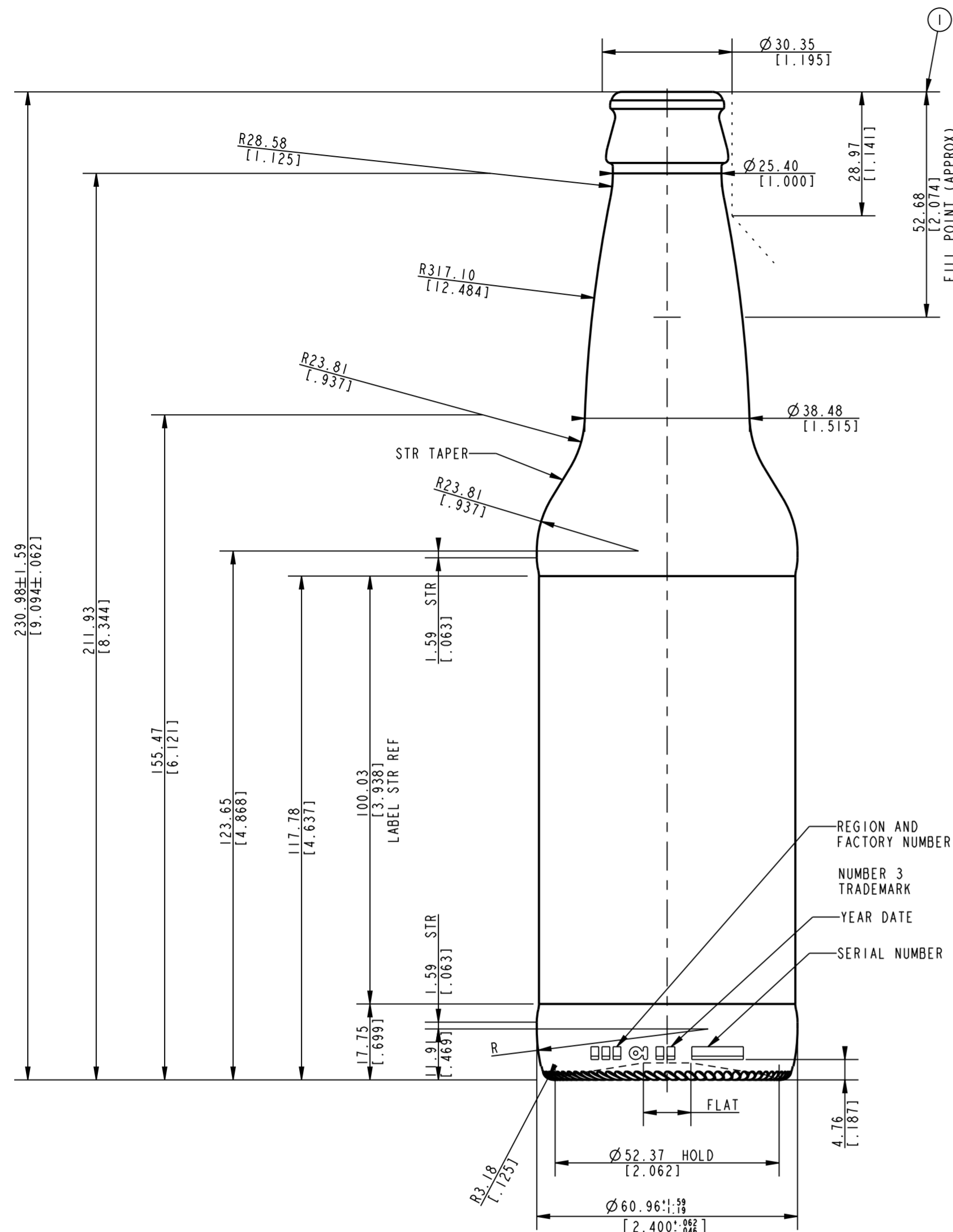

**LABEL INDENT
DETAIL**
SCALE 4.000

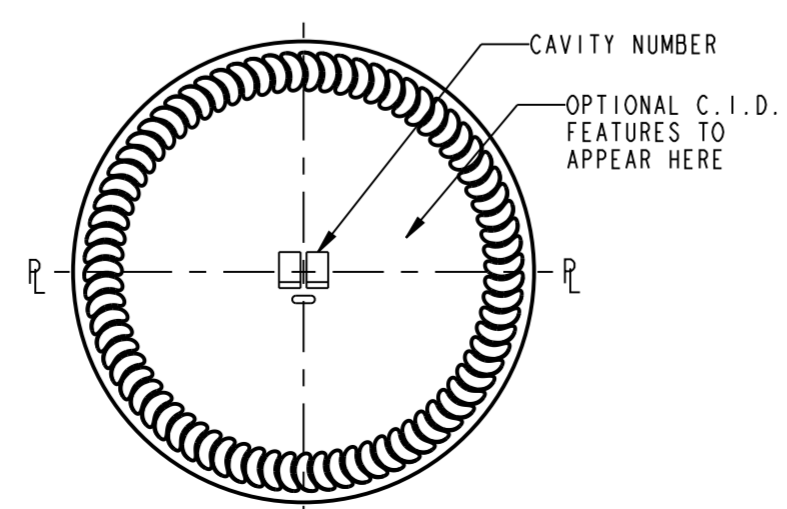
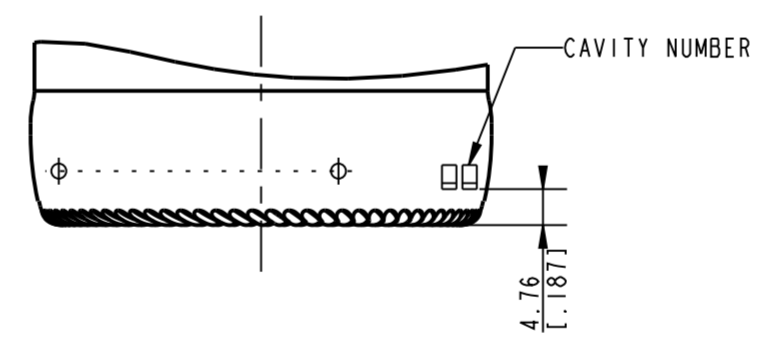

INFORMATION CONTAINED HEREIN CONSTITUTES PROPRIETARY CONFIDENTIAL INFORMATION OF OWENS-BROCKWAY GLASS CONTAINER INC. AND IS TO BE ACCEPTED ONLY SUBJECT TO THAT UNDERSTANDING. IT IS TO BE KEPT CONFIDENTIAL AND NOT TO BE COPIED, USED OR CONVEYED TO OTHERS WITHOUT OWENS-BROCKWAY GLASS CONTAINER INC WRITTEN AUTHORIZATION.

ALL LETTERING TO BE ROUND BOTTOM STYLE, RAISED IN GLASS, UNLESS OTHERWISE NOTED.

CAPACITY VALUES BASED ON WATER AT 20°C [68°F]

ALL NON TOLERANCE SIZES ARE FOR MOLD MANUFACTURE REFERENCE ONLY.

MNPB/B&B OPERATION ONLY

APPROX. STABILITY PROPERTIES		EMPTY	FULL
CENTER OF GRAVITY (IN INCHES)		3.63	3.36
BOTTLE STABILITY RATIO		0.54	0.58
TIP ANGLE (IN DEGREES)		15.1	16.3

No	DATE	REVISIONS	DESIGN/CHECK
-7	23 JUN 08	ADDED 026-0500-R007 AS SECONDARY FINISH; REMOVED 026-0500-R004 FINISH; UPDATED PRESSURIZATION NOTES.	ERA

SHEET 1 OF 3

CONTAINER OVERFLOW CAPACITY (BRIMFUL)			
378.84 ml ± 5.55 ml [12.810 FL OZ ± 0.188 FL OZ]			
CONTAINER RATED CAPACITY (FILLPOINT)			
354.88 ml [12.000 FL OZ]			
CONTAINER WEIGHT			
226.80 g ± 8.86 g [8.000 OZ ± 0.313 OZ]			
FINISH DESIGNATION 026-0611-R002		MAX GAS VOLUME 4.0 Gas Vol	
PROCESS B&B	RETURNABLE NO	DESIGN REF. C-91229-GC	
STOCK			
12 FL. OZ. LONG NECK NON-REFILLABLE			
DESIGNER	DCM	DATE	25 FEB 97
CHECKED		DATE	
DRAWING NUMBER BE-34158-7		MOULD/SAP NUMBER GB-16238	